

March 2019



CAPITAL PROJECTS REPORT
to the

Citizens' Oversight Committee

MAAS

Intentionally Left Blank

TABLE OF CONTENTS

Projects in Feasibility, Planning, Programming, Design, and Construction

CAMPUS SITE PLANS

<i>Cypress Campus</i>	3
<i>Fullerton Campus</i>	4
<i>Anaheim Campus</i>	5

Project Status Report

Cypress Campus

<i>New Science, Engineering, and Mathematics Building</i>	8
<i>New Veterans' Resource Center, Student Activities Center Expansion</i>	9
<i>Veterans' Memorial Bridge and Tribute Garden</i>	10
<i>Pond Refurbishment</i>	11
<i>Swing Space Projects</i>	12
<i>Update / Improve Infrastructure</i>	13-14
<i>Mass Communication and Security Systems Upgrade</i>	15-17
<i>Updates on Campus Projects - Cypress College</i>	18-22

Fullerton Campus

<i>New Instructional Building</i>	24
<i>Renovate Buildings 300 & 500</i>	25
<i>New TES & Chilled Water Plant Expansion</i>	26
<i>New Parking Structure</i>	27
<i>New Maintenance & Operations Building</i>	28
<i>Update / Improve Infrastructure</i>	29-30
<i>Updates on Campus Projects - Fullerton College</i>	31-34

Anaheim Campus

<i>7th and 10th Floors Buildout</i>	36
<i>5th Floor CTE Laboratory and 2nd Floor Room 215</i>	37
<i>Update / Improve Infrastructure</i>	38
<i>Updates on Campus Projects - Anaheim Campus</i>	39-40

Financial Review

CAPITAL PROJECT UPDATES

<i>Measure J</i>	42
------------------------	----

ESTIMATED PROJECT BUDGETS

<i>Cypress Campus</i>	44-45
<i>Fullerton Campus</i>	46-47
<i>Anaheim Campus</i>	48-49
<i>District</i>	50-51

90-DAY LOOK AHEAD SCHEDULE

<i>Cypress/Fullerton/Anaheim/District</i>	52
---	----

Intentionally Left Blank

PROJECTS IN FEASIBILITY, PLANNING, PROGRAMMING, AND DESIGN

- Campus Site Plans
- Project Status Reports



Intentionally Left Blank

SITE PLAN — CYPRESS CAMPUS

FEASIBILITY, PLANNING, PROGRAMMING & DESIGN

- New Science, Engineering and Mathematics Building
- New Veterans' Resource Center & Student Activities Center Expansion
- Veterans' Memorial Bridge and Tribute Garden
- Swing Space Projects
- Update / Improve Infrastructure
- Mass Communication and Security Systems Upgrade



SITE PLAN — FULLERTON CAMPUS

FEASIBILITY, PLANNING, PROGRAMMING & DESIGN

- Renovate Buildings 300 & 500
- New Instructional Building
- New TES & Chilled Water Plant Expansion
- New Parking Structure
- Update / Improve Infrastructure

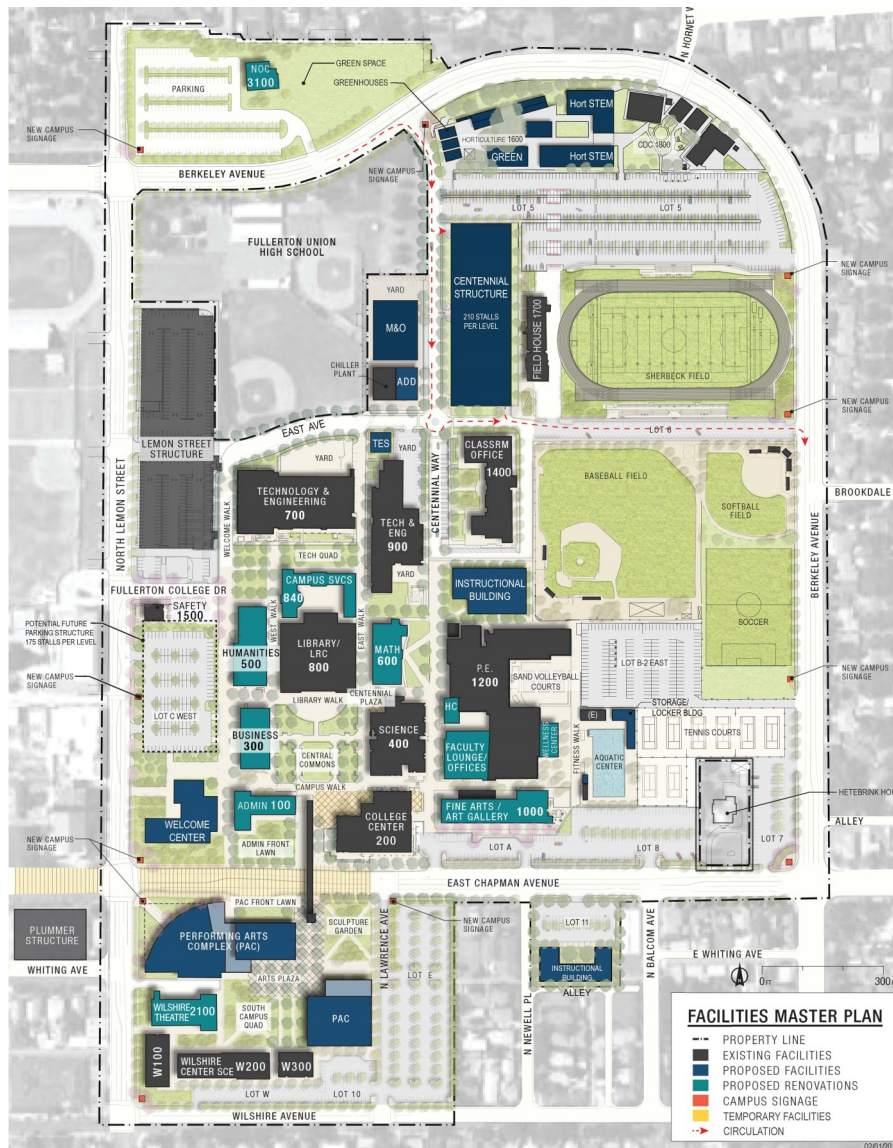

SITE PLAN — ANAHEIM CAMPUS

FEASIBILITY, PLANNING, PROGRAMMING & CONSTRUCTION

- Anaheim 7th & 10th Floors Buildout
- 5th Floor CTE Laboratory and 2nd Floor Counseling Office Room 215
- All Project Scopes, Budgets, Schedules and Priorities under review. Program Requirements in Early Planning Phases.
 - 1st Floor Upgrades
 - Upper Parking Lot Refurbishment (TBD)
- Update / Improve Infrastructure

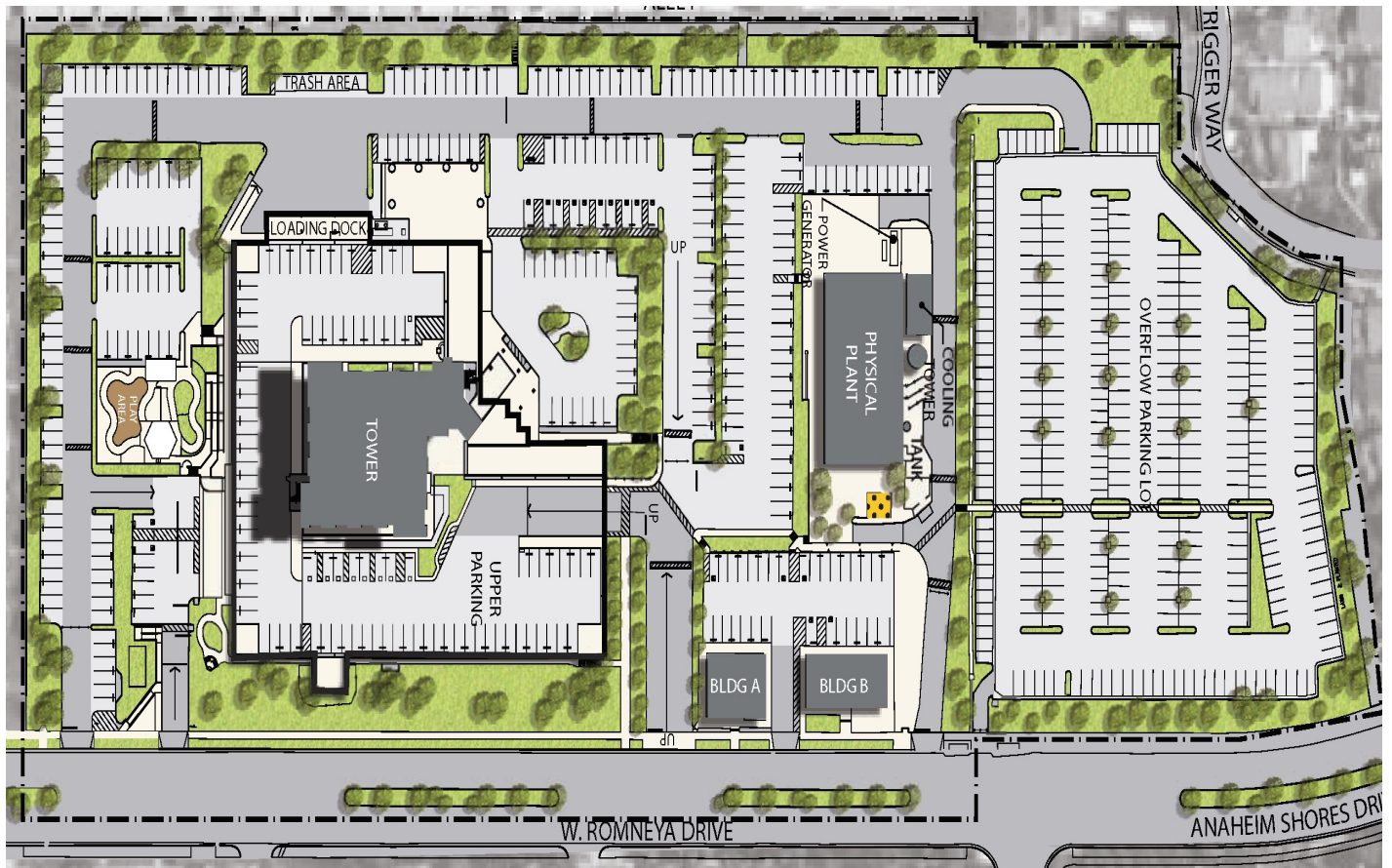

Intentionally Left Blank

AERIAL VIEW — CYPRESS CAMPUS

CAMPUS PROJECTS

Veterans' Memorial Bridge
& Tribute Garden
[Construction]



New Science, Engineering
and Mathematics Building
[Construction]



Swing Space Projects
Parking Lot #5
[Close-Out]



- ▶ IT Network Refresh (Throughout Campus) [Bidding]
- ▶ Mass Communication & Security Systems Upgrade - Safety Film (6 Buildings on Campus) [Close-Out]
- ▶ Mass Communication & Security Systems Upgrade - Door Replacement (Building 9) [Close-Out]



New Veterans' Resource Center &
Student Activities Center Expansion
[Construction]



PROJECT STATUS REPORT – CYPRESS CAMPUS

NEW SCIENCE, ENGINEERING, AND MATHEMATICS BUILDING

CONSTRUCTION

Address	9200 Valley View St. Cypress, CA 90630
Project Manager	Ryan Lippmann Cypress College
Architect	LPA, Inc.
Construction	Sundt Construction, Inc.
Project Gross Square Footage	106,023 GSF
DSA Application A#	04-117024

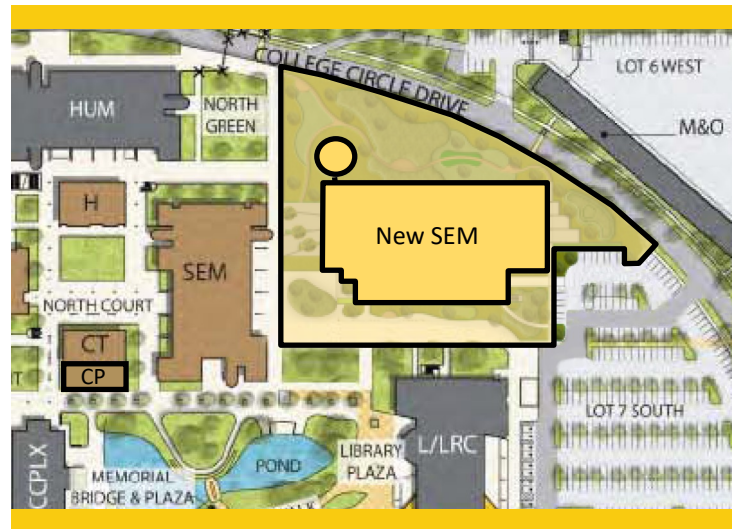

Project Overview

High priority project to increase the efficiency of the square footage and accommodation of services for Science, Engineering, and Mathematics programs with 21 lecture and 23 lab classrooms, an Immersive Digital Classroom (IDC), and a Crematorium for the Mortuary Science Program.

Budget & Construction Costs

- Funding Sources Measure J & Campus
- Total Project Budget (Est.)* \$97,263,787
 - Measure J (Est.)* \$94,263,787
 - Campus Funds (Est. FF&E) \$3,000,000
- Construction Cost \$80,532,546
 - Allowance Used \$0
 - CM Contingency Used \$0

*These values are not reconciled on the financial and allocation reports

Schedule

- Design Start Jun. 29, 2016
- Construction Start Feb. 6, 2019
- Targeted Substantial Completion Feb. 2021
- Targeted Construction Completion Apr. 2021
- Targeted Academic Occupancy Jun. 2021

PROJECT STATUS REPORT – CYPRESS CAMPUS

NEW VETERANS' RESOURCE CENTER & STUDENT ACTIVITIES CENTER EXPANSION CONSTRUCTION

Address	9200 Valley View St. Cypress, CA 90630
Project Manager	Ryan Lippmann Cypress College
Architect	LPA, Inc.
Construction	Sundt Construction, Inc.
Project Gross Square Footage	12,119 GSF
DSA Application A#	04-117023



Project Overview

High priority project to increase the square footage and provide new accommodation of services for the Veterans' Resource Center (VRC)/Student Activities Center (SAC) Expansion.

Budget & Construction Costs

- Funding Sources..... Measure J
- Total Project Budget (Est.)\$13,500,000
 Measure J (Est.)\$13,500,000
- Construction Cost.....\$9,834,698
 Allowance Used\$0
 CM Contingency Used\$0

Schedule

- Design Start Dec. 9, 2016
- Construction Start Feb. 6, 2019
- Targeted Substantial CompletionJun. 2020
- Targeted Construction Completion.....Aug. 2020
- Targeted Academic Occupancy..... Sep. 2020



PROJECT STATUS REPORT – CYPRESS CAMPUS

VETERANS’ MEMORIAL BRIDGE AND TRIBUTE GARDEN CONSTRUCTION

Address	9200 Valley View St. Cypress, CA 90630
Project Manager	Ryan Lippmann Cypress College
Architect	LPA, Inc.
Construction Manager at Risk	Sundt Construction, Inc.
Project Square Footage	63,192 SF
DSA Application A#	04-117023



Project Overview

Construction of a Veterans’ Memorial Bridge (VMB), Tribute Garden, and site improvements to adjacent areas, including VRC Plaza.

Budget & Construction Costs

- Funding Sources..... Measure J & Local
- Total Project Budget (Est.) \$1,600,800
 - Measure J (Est.) \$1,500,000
 - Local (Est.)..... \$100,800
- Construction Cost..... \$1,138,359
 - Allowance Used \$0
 - CM Contingency Used \$0

Schedule

- Design Start Dec. 9, 2016
- Construction Start Feb. 6, 2019
- Targeted Substantial Completion Dec. 2019
- Targeted Construction Completion..... Apr. 2020
- Targeted Occupancy Apr. 2020



PROJECT STATUS REPORT – CYPRESS CAMPUS

POND REFURBISHMENT CONSTRUCTION

Address	9200 Valley View St. Cypress, CA 90630
Project Manager	Ryan Lippmann Cypress College
Architect	LPA, Inc.
Construction Manager at Risk	Sundt Construction, Inc.
Project Square Footage	16,357 GSF
DSA Application A#	04-117023



Project Overview

Repairs and refurbishment of existing ponds. Replacement of pond lining and rearrangement of water features.

Budget & Construction Costs

- Funding Sources..... Local
- Total Project Budget (Est.) \$682,017
 - Local (Est.)..... \$682,017
- Construction Cost..... \$546,468
 - Allowance Used \$0
 - CM Contingency Used \$0

Schedule

- Design Start Dec. 9, 2016
- Construction Start Feb. 6, 2019
- Targeted Substantial Completion. Dec. 2019
- Targeted Construction Completion..... Apr. 2020
- Targeted Occupancy Apr. 2020



PROJECT STATUS REPORT – CYPRESS CAMPUS

SWING SPACE PROJECTS

CLOSE-OUT

Address	9200 Valley View St. Cypress, CA 90630
Project Manager	Ryan Lippmann / Phil Flemming Cypress College
Architect	(See Updates on Projects)
Project Delivery Method	(See Updates on Projects)



Project Overview

Currently, there were three different ventures that were part of the Swing Space Projects. Roof repairs were performed using Scheduled Maintenance Funds at the existing SEM Building, which will be occupied as a swing space upon the completion of the New SEM building. Available space within Gym II is accommodating the Student Activities Center (SAC) activities during construction of the New VRC/SAC. Parking Lot 5 South was reconfigured aiming to increase parking capacity by 385 spaces to compensate for the loss of 200 stalls resulting from the construction site for the New SEM Building.

- Total Project Budget\$3,236,521
- Funding SourceMeasure J
 - Parking Lot #5\$2,300,000 (Estimated)
 - VRC / SAC Swing Space to Gym II.....\$200,000 (Estimated)
 - Unallocated Balance\$736,521 (Estimated)
- Construction Start
 - Parking Lot #5June 2018 (Complete)
 - VRC / SAC Swing Space to Gym II.....May 2018 (Complete)
- Targeted Completion
 - Parking Lot #5September 2018 (Complete)
 - VRC / SAC Swing Space to Gym II.....July 2018 (Complete)

PROJECT STATUS REPORT – CYPRESS CAMPUS

UPDATE/IMPROVE INFRASTRUCTURE

VARIOUS STAGES

Address	9200 Valley View St. Cypress, CA 90630	Total Project Budget	\$24,337,832
		Total Budget Allocated	\$9,928,938
Number of Projects	3	Funding Source	Measure J

General Overview

Projects to address infrastructure improvements or upgrades throughout the Campus. Funds are allocated to projects as needs are identified.

IT Network Refresh Project Overview

BIDDING

Assessment of Campus data network infrastructure to identify necessary upgrades and changes that will enable supporting future campus needs; specifically addressing wired, wireless, voice, and video networks. Design of a new network will account for the District’s needs specific to logical infrastructure for the next 10 years. Physical infrastructure will also account for the District’s needs for the next 20 years. The scope includes replacing network core switches, providing a more responsive support structure, preparing for cloud computing, and adaptation of voice over IP systems across the District.

- Project Budget\$6,000,000
- Funding SourceMeasure J & Capital Outlay Funds
- Project Delivery MethodCompetitive Bid - Best Value
- Architect.....Shandam Consulting
- Project ManagementDistrict IS / PlanNet Consulting
- Estimated Design Implementation Start.....Spring 2019
- Targeted CompletionWinter 2019



PROJECT STATUS REPORT – CYPRESS CAMPUS

UPDATE/IMPROVE INFRASTRUCTURE (Continued)

New Science, Engineering, and Mathematics Building Infrastructure

Project Overview

CONSTRUCTION

Improvements to Campus power and sewer infrastructure to connect to the future New SEM Building. The scope of work includes storm water drain relocation, water supply reconfiguration, sanitary sewer replacement, gas and mechanical utilities rearrangement, site lighting, and electrical duct bank relocation.

Project Delivery Method	Architect	Construction Manager at Risk	Project Manager
Construction Manager at Risk (CMAR)	LPA, Inc.	Sundt Construction, Inc.	Ryan Lippmann

Budget & Construction Costs

- Funding Sources..... Measure J
- Total Project Budget (Est.) \$2,854,576
 - Measure J (Est) \$2,854,576
- Construction Cost \$2,854,576
 - CM Allowance Used \$0
 - District Allowance Used \$0
 - CM Contingency Used \$0

Schedule

- Design Start Mar. 27, 2017
- Construction Start Feb. 6, 2019
- Targeted Substantial Completion Feb. 2021
- Targeted Construction Completion Apr. 2021
- Targeted Occupancy Apr. 2021

New VRC/SAC Expansion Building Infrastructure

Project Overview

CONSTRUCTION

Improvements to Campus infrastructure in the vicinity of the new VRC/SAC building expansion. The scope of work includes storm water drain relocation, water supply reconfiguration, sanitary sewer replacement, gas and mechanical utilities rearrangement, site lighting, and electrical duct bank relocation.

Project Delivery Method	Architect	Construction Manager at Risk	Project Manager
Construction Manager at Risk (CMAR)	LPA, Inc.	Sundt Construction, Inc.	Ryan Lippmann

Budget & Construction Costs

- Funding Sources..... Measure J
- Total Project Budget (Est.) \$1,074,362
 - Measure J (Est.) \$1,074,362
- Construction Cost \$1,074,362
 - CM Allowance Used \$0
 - District Allowance Used \$0
 - CM Contingency Used \$0

Schedule

- Design Start Mar. 27, 2017
- Construction Start Feb. 6, 2019
- Targeted Substantial Completion Jun. 2020
- Targeted Construction Completion Aug. 2020
- Targeted Occupancy Aug. 2020



PROJECT STATUS REPORT — CYPRESS CAMPUS

MASS COMMUNICATION & SECURITY SYSTEMS UPGRADE

VARIOUS STAGES

Address	9200 Valley View St. Cypress, CA 90630	Total Project Budget	\$4,648,500
		Total Budget Allocated	\$569,330
Number of Projects	4	Funding Source	Measure J

General Overview

Projects to address fire alarm, mass communication, security, access control, and lockdown systems throughout the Campus. Funds are allocated to projects as needs are identified.

New Science, Engineering, and Mathematics Building, Mass Communication & Security Systems Project Overview

CONSTRUCTION

Installation of safety film and improvements to Campus fire alarm and security system to connect to the future New SEM Building.

Project Delivery Method	Architect	Construction Manager at Risk	Project Manager
Construction Manager at Risk (CMAR)	LPA, Inc.	Sundt Construction, Inc.	Ryan Lippmann

Budget & Construction Costs

- Funding Sources.....Measure J
- Total Project Budget (Est.).....\$310,883
- Measure J (Est.).....\$310,883
- Construction Cost\$310,883
- CM Allowance Used\$0
- District Allowance Used\$0
- CM Contingency Used\$0

Schedule

- Design StartMar. 27, 2017
- Construction Start Feb. 6, 2019
- Targeted Substantial Completion..... Feb. 2021
- Targeted Construction Completion Apr. 2021
- Targeted Occupancy..... Apr. 2021



PROJECT STATUS REPORT – CYPRESS CAMPUS

MASS COMMUNICATION & SECURITY SYSTEMS UPGRADE (Continued)

New VRC/SAC Expansion, Mass Communication & Security Systems Project Overview

CONSTRUCTION

Installation of safety film and improvements to Campus fire alarm and security system to connect to the future New VRC/SAC Expansion.

Project Delivery Method	Architect	Construction Manager at Risk	Project Manager
Construction Manager at Risk (CMAR)	LPA, Inc.	Sundt Construction, Inc.	Ryan Lippmann

Budget & Construction Costs

- Funding Sources..... Measure J
- Total Project Budget (Est.)\$62,002
Measure J (Est.)\$62,002
- Construction Cost\$62,002
CM Allowance Used\$0
District Allowance Used\$0
CM Contingency Used\$0

Schedule

- Design Start..... Mar. 27, 2017
- Construction Start..... Feb. 6, 2019
- Targeted Substantial Completion Jun. 2020
- Targeted Construction Completion Aug. 2020
- Targeted Occupancy Aug. 2020

Safety Film Project Overview

CLOSE-OUT

Installation of safety film at 6 buildings on campus. Among them are Building 3 SEM, Building 7 Gym I, Building 8 Student Activities, Building 11 Gym II, Building 12 Tech Ed II, and Building 20 Bookstore.

Project Delivery Method	Architect	General Contractor	Project Manager
CUPCCAA Approved	N/A	N/A	Ryan Lippmann

Budget & Construction Costs

- Funding Sources..... Measure J
- Total Project Budget (Est.)\$145,774
Measure J (Est.)\$145,774
- Construction Cost\$145,774

Schedule

- Design Start..... N/A
- Construction Start..... Apr. 24, 2018
- Targeted Substantial Completion Sep. 19, 2018
- Targeted Construction Completion Sep. 19, 2018
- Targeted Occupancy N/A



PROJECT STATUS REPORT — CYPRESS CAMPUS

MASS COMMUNICATION & SECURITY SYSTEMS UPGRADE (Continued)

Door Replacement Project Overview

CLOSE-OUT

Installation of modified entry doors at Building 9 Business Education.

Project Delivery Method	Architect	General Contractor	Project Manager
CUPCCAA Approved	N/A	N/A	Ryan Lippmann

Budget & Construction Costs

- Funding Sources Measure J
- Total Project Budget (Est.)\$50,671
- Measure J (Est.)\$50,671
- Construction Cost.....\$50,671

Schedule

- Design Start N/A
- Construction Start Apr. 24, 2018
- Targeted Substantial Completion Jan. 2, 2019
- Targeted Construction Completion..... Jan 2, 2019
- Targeted Occupancy N/A



PROJECT STATUS REPORT – CYPRESS CAMPUS

UPDATES ON CAMPUS PROJECTS - CYPRESS COLLEGE

New Science, Engineering, and Mathematics Building

- The Board of Trustees authorized the District on January 22nd to issue a construction contract to Sundt for a Guaranteed Maximum Price (GMP) of \$92,052,341 for the bundled project which includes the New SEM, New VRC/SAC Renovation, Veterans’ Memorial Bridge and Tribute Gardens, and Pond Refurbishment. Of this amount \$80,532,546 correspond to the New SEM and ancillary infrastructure and mass communications projects.
- The Campus has set aside \$3,000,000 in funds for the building’s furniture, fixtures, and equipment (FF&E). Dovetail has reviewed furniture needs for the building with the intent of maximizing reuse of furniture and equipment from the existing building, and is currently compiling a revised estimate for FF&E. Funds from additional sources might be allocated to address shortfalls in FF&E needs.
- The stamped documents by DSA have a series of deferred approvals that will be submitted for the agency’s review and approval prior to installation to the building. The following is a list of the deferred approvals for this project:

Elevator Guide Rails and Support Brackets	Window Wall Systems over 10’-0” Vertical Span	Ultra High Performance Concrete (UHPC) Rainscreen System
IDC Suspended Projection Dome Ceiling	Greenhouse Glazing Assembly Systems for Walls and Roof	

- Groundbreaking for project took place on February 6th 2019 with the issuance of the Notice to Proceed (NTP), as forecasted on recent meetings with the Architect of Record and Construction Manager. Groundbreaking ceremonies were held on February 8th, 2019.
- The current foundation driven pile count could involve 10 weeks of work with a single rig, or 5 weeks with two rigs. Noise limits and/or abatement measures or requirements were requested to be incorporated in the bid specifications. A meeting with designers and pile contractors took place to evaluate options on noise mitigation. Noise monitoring consultants will be involved in the project to evaluate noise impact via a professional study, opinion and extenuation plan in order to reduce and mitigate any complaints from the neighboring community and/or students and faculty. The College is working with Dudek for an amendment to the current EIR for public distribution following adoption.
- The District has released to prequalified vendors a Request for Proposals (RFP) for Inspector of Record (IOR) services for the bundled project including the New SEM, New VRC/SAC Renovation, Veterans’ Memorial Bridge and Tribute Gardens, and Pond Refurbishment. Responses are due to the District on February 6th, 2019. Shortlist decisions, interviews, and selection of vendor dates are still to be determined.

New Veterans’ Resource Center & Students Activities Center Expansion

- The Board of Trustees authorized the District on January 22nd to issue a construction contract to Sundt for a Guaranteed Maximum Price (GMP) of \$92,052,341 for the bundled project which includes the New



PROJECT STATUS REPORT – CYPRESS CAMPUS

UPDATES ON CAMPUS PROJECTS - CYPRESS COLLEGE (Continued)

SEM, New VRC/SAC Renovation, Veterans' Memorial Bridge and Tribute Gardens, and Pond Refurbishment. Of this amount \$9,834,968 correspond to the New VRC/SAC and ancillary infrastructure and mass communications projects.

- Scope of work encompassing pond refurbishment beyond the necessary for completion of the new VRC will be completed using one-time Campus funding.
- The stamped documents by DSA have a series of deferred approvals that will be submitted for the agency's review and approval prior to installation to the building. The following is a list of the deferred approvals for this project:

Polished Concrete Resilient Flooring

Curtain Wall Façade Alternates

- LPA completed the addition of fire sprinklers to the project. Previous plans did not account for the low fire hydrant flows. This item will be issued as an addendum to DSA during bidding, and is included in the scope of work for the project under the agreed Guaranteed Maximum Price (GMP).
- A Notice to Proceed was issued to Sundt Construction on February 6th, 2019. The campus is planning on a groundbreaking ceremony for this building on March 15th, 2019.
- The District has released to prequalified vendors a Request for Proposals (RFP) for Inspector of Record (IOR) services for the bundled project including the New SEM, New VRC/SAC Renovation, Veterans' Memorial Bridge and Tribute Gardens, and Pond Refurbishment. Responses are due to the District on February 6th, 2019. Shortlist decisions, interviews, and selection of vendor dates are still to be determined.

Veterans' Memorial Bridge and Tribute Garden

- The Board of Trustees authorized the District on January 22nd to issue a construction contract to Sundt for a Guaranteed Maximum Price (GMP) of \$92,052,341 for the bundled project which includes the New SEM, New VRC/SAC Renovation, Veterans' Memorial Bridge and Tribute Gardens, and Pond Refurbishment. Of this amount \$1,138,359 correspond to the Veterans' Memorial Bridge and Tribute Gardens.
- Scope of work encompassing pond refurbishment beyond the necessary for completion of the new VRC will be completed using one-time Campus funding.
- A Notice to Proceed was issued to Sundt Construction on February 6th, 2019. The campus is planning on a groundbreaking ceremony for this building on March 15th, 2019.
- The District has released to prequalified vendors a Request for Proposals (RFP) for Inspector of Record (IOR) services for the bundled project including the New SEM, New VRC/SAC Renovation, Veterans' Memorial Bridge and Tribute Gardens, and Pond Refurbishment. Responses are due to the District on February 6th, 2019. Shortlist decisions, interviews, and selection of vendor dates are still to be determined.



PROJECT STATUS REPORT — CYPRESS CAMPUS

UPDATES ON CAMPUS PROJECTS - CYPRESS COLLEGE (Continued)

Pond Refurbishment

- The Board of Trustees authorized the District on January 22nd to issue a construction contract to Sundt for a Guaranteed Maximum Price (GMP) of \$92,052,341 for the bundled project which includes the New SEM, New VRC/SAC Renovation, Veterans' Memorial Bridge and Tribute Gardens, and Pond Refurbishment. Of this amount \$549,468 correspond to the Pond Refurbishment repairs to be paid by Cypress College funds.
- Scope of work encompassing pond refurbishment beyond the necessary for completion of the new VRC will be completed using one-time Campus funding.
- A Notice to Proceed was issued to Sundt Construction on February 6th, 2019. The campus is planning on a groundbreaking ceremony for this building on March 15th, 2019.
- The District has released to prequalified vendors a Request for Proposals (RFP) for Inspector of Record (IOR) services for the bundled project including the New SEM, New VRC/SAC Renovation, Veterans' Memorial Bridge and Tribute Gardens, and Pond Refurbishment. Responses are due to the District on February 6th, 2019. Shortlist decisions, interviews, and selection of vendor dates are still to be determined.

Swing Space Projects

- Parking Lot #5 Expansion - GB Construction, Inc. dba Golden Bear Construction completed construction activities at the project site. The project has entered the close-out phase.
- A notice of completion was filed with the Board of Trustees on January 22nd, 2019 and Orange County Clerk on January 24th, 2019. Golden Bear Construction will be invoicing for payment on construction retention for \$64,231.43.
- Veterans' Resource Center / Student Activities Center move to Swing Space at Gym II - Personnel move to the renovated swing space was completed in June. The project is in the close-out phase.

Update / Improve Infrastructure

IT Network Refresh Project

- District IS and Purchasing Departments posted the Request for Proposals (RFP) to the public on August 6th, 2018. The deadline for submitting questions regarding the RFP was August 31st. Answers were to be issued by the middle of September. Responses to the RFP were due on November 6th, 2018, and were followed by vendor presentations on November 15th, 2018. As the RFP evaluation process has been completed, approximately by the end of November 2018, interviews were conducted in December 2018. The goal is to have the selected vendor to start implementation of design during the first quarter of 2019.
- A vendor has been selected and a recommendation to award contract will be presented to the Board of Trustees in March 2019.



PROJECT STATUS REPORT – CYPRESS CAMPUS

UPDATES ON CAMPUS PROJECTS - CYPRESS COLLEGE (Continued)

- The successful vendor is required to submit a project plan as part of their response to demonstrate how they would successfully implement the new architecture. The project plan should show the schedule, resources, and dependences including projected work effort, in hours, for each milestone and subordinated to activities within each phase (i.e. Project, Phase, Milestone/Deliverable, Activity and Task). Submit hours and labor rates for staffing levels (i.e. Network Administration, Security, Architect) for each phase. The selection of an independent verification entity will be proceeding in the upcoming months.
- The design process is not funded by Bond Measures X or J. However, the construction and implementation phase will be bond-funded by Measure J. Equipment will be owner furnished, owner installed.

New Science, Engineering, and Mathematics Building Infrastructure

- Groundbreaking for project took place on February 8th 2019 with the issuance of the Notice to Proceed (NTP) on February 6th, 2019, as forecasted on recent meetings with the Architect of Record and Construction Manager.
- RFPs for Inspector of Record was released to pre-qualified vendors with a due date of February 6th, 2019. Evaluation of proposals and interviews will take place later this month.

New VRC/SAC Expansion Building Infrastructure

- A Notice to Proceed was issued to Sundt Construction on February 6th, 2019. The campus is planning on a groundbreaking ceremony for this building on March 15th, 2019.
- RFPs for Inspector of Record was released to pre-qualified vendors with a due date of February 6th, 2019. Evaluation of proposals and interviews will take place later this month.

Mass Communication and Security Systems Upgrade

New Science, Engineering, and Mathematics Building, Mass Communication & Security System Project

- Groundbreaking for project took place on February 8th 2019 with the issuance of the Notice to Proceed (NTP) on February 6th, 2019, as forecasted on recent meetings with the Architect of Record and Construction Manager.
- RFPs for Inspector of Record was released to pre-qualified vendors with a due date of February 6th, 2019. Evaluation of proposals and interviews will take place later this month.

New VRC/SAC Expansion, Mass Communication & Security System Project

- A Notice to Proceed was issued to Sundt Construction on February 6th, 2019. The campus is planning on a groundbreaking ceremony for this building on March 15th, 2019.
- RFPs for Inspector of Record was released to pre-qualified vendors with a due date of



UPDATES ON CAMPUS PROJECTS - CYPRESS COLLEGE (Continued)

February 6th, 2019. Evaluation of proposals and interviews will take place later this month.

Safety Film Project

- Construction activities for this project have concluded. Cost for project is estimated at \$145,774. The project is in the close-out phase.

Door Replacement Project

- Door installation was completed on January 2nd, 2019. The project budget is pending allocation of additional funds from previously estimated \$50,671.



AERIAL VIEW — FULLERTON CAMPUS

CAMPUS PROJECTS

- IT Network Refresh (Throughout Campus)
[Bidding]

Update / Improve
Infrastructure - Sewer Line
Replacement to Buildings
300 & 500
[Agency Review]

New TES & Chilled Water
Plant Expansion
[Phase I - Schematic
Design]

New Maintenance & Operations
Building
[Pre-Planning]

New Parking Structure
[Pre-Planning]



Renovate Buildings 300 & 500
[Construction Documents]

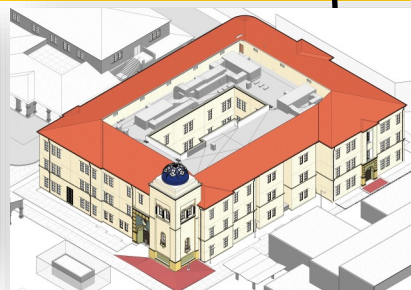

New Instructional
Building
[Construction
Documents]



PROJECT STATUS REPORT — FULLERTON CAMPUS

NEW INSTRUCTIONAL BUILDING CONSTRUCTION DOCUMENTS

Address	321 E. Chapman Ave. Fullerton, CA 92832
Project Manager	Oscar Saghieh Fullerton College
Design-Builder	BNBuilders, Inc, & Roesling Nakamura Terada Architects, Inc.
Project Delivery Method	Progressive Design- Build

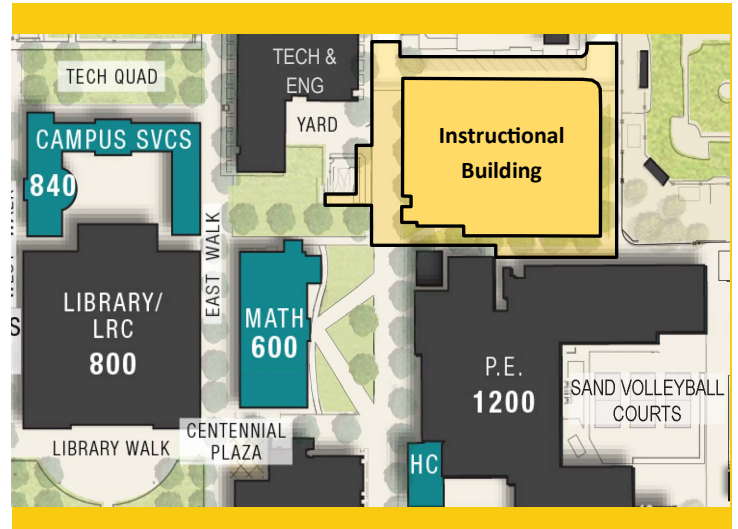

Project Overview

The building will help meet campus growth needs with the goal of consolidating an instructional division into a single building. The building will accommodate more than 40 classrooms and the division office services including staff offices. Scope of work for this projects includes the expansion of the Chilled Water plant. Refer to page 31 of this report for information.

- Total Project Budget\$54,000,000
- Funding SourceMeasure J
- Project Gross Square Footage74,927 GSF
- Estimated Construction Start.....Winter 2019
- Targeted CompletionSummer 2021



PROJECT STATUS REPORT – FULLERTON CAMPUS

RENOVATE BUILDINGS 300 & 500 CONSTRUCTION DOCUMENTS

Address	321 E. Chapman Ave. Fullerton, CA 92832
Project Manager	Oscar Saghieh Fullerton College
Architect	R2A Architecture
Project Delivery Method	Design-Bid-Build

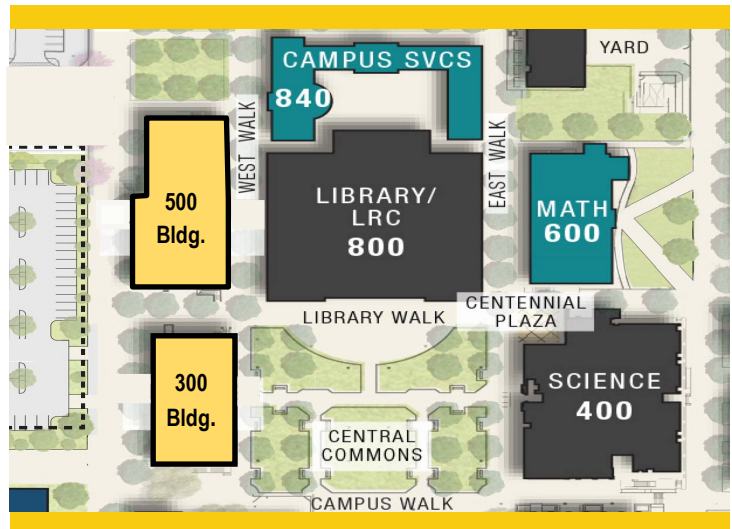

Project Overview

Total renovation of Buildings 300 and 500, including historic consideration of Building 300. The renovated buildings will contain general classrooms, CIS laboratories, ACT laboratories, photography laboratories, Dean and faculty offices, shared laboratories, and a lecture hall.

- Total Project Budget\$35,882,000
- Funding SourceMeasure J & State Capital Outlay
 - Measure J\$20,482,000
 - State Capital Outlay Funds\$15,400,000
- Project Gross Square Footage.....55,451 GSF
- Estimated Construction Start.....Summer 2021
- Targeted CompletionWinter 2022/23



PROJECT STATUS REPORT — FULLERTON CAMPUS

NEW TES & CHILLED WATER PLANT EXPANSION PHASES I & II SCHEMATIC DESIGN

Address	321 E. Chapman Ave. Fullerton, CA 92832
Project Manager	Oscar Saghieh Fullerton College
Design-BUILDER (Phase I)	BNBuilders, Inc, & Roesling Nakamura Terada Architects, Inc.
Project Delivery Method (Phase I)	Progressive Design-Build

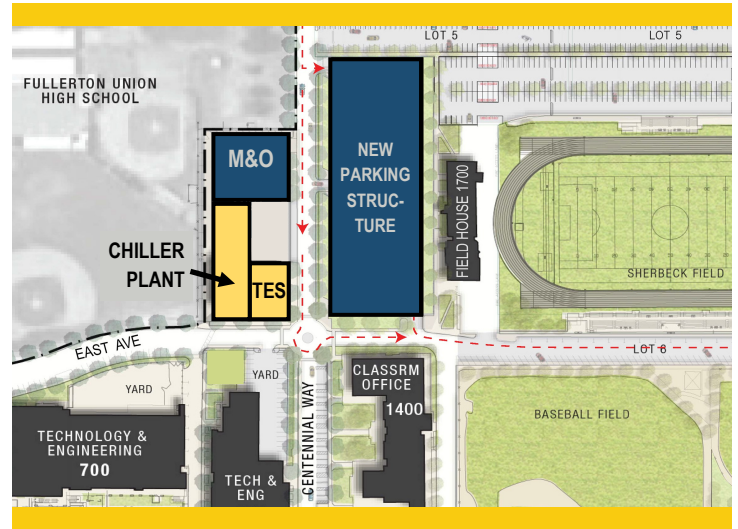

Project Overview

Expansion of the Chilled Water Plant to accommodate planned new facilities and renovations along with new Thermal Energy Storage. Phase I includes the expansion of the existing building to house the addition of a 600-ton high-efficiency water chiller, and future additions in subsequent project phases. Phase II scope of work will be revisited as Phase I construction nears completion.

- Total Project Budget\$12,139,524
 - Phase I and Phase II\$2,000,000
 - Thermal Energy Storage (TES)\$10,139,524
- Funding SourceMeasure J
- Project Gross Square Footage.....TBD
- Estimated Construction Start for Phase I.....Winter 2019
- Targeted Completion for Phase ISummer 2021



PROJECT STATUS REPORT — FULLERTON CAMPUS

NEW PARKING STRUCTURE PRE-PLANNING

Address	321 E. Chapman Ave. Fullerton, CA 92832
Project Manager	Oscar Saghieh Fullerton College
Architect	TBD
Project Delivery Method	TBD

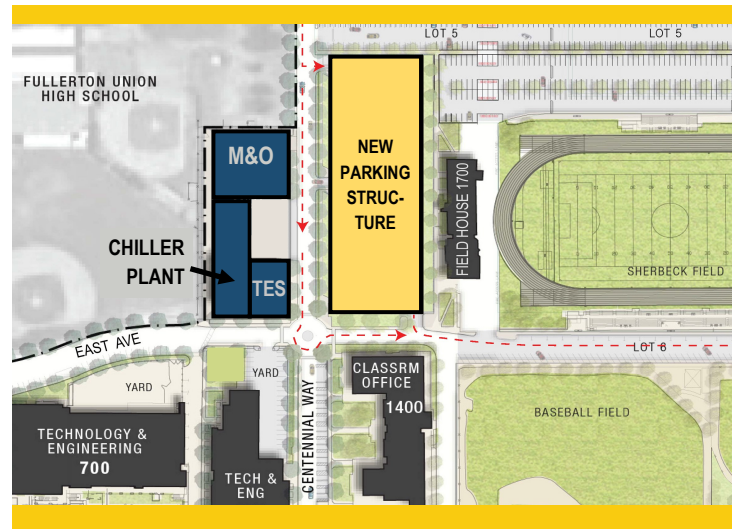

Project Overview

New parking structure building to accommodate the need for additional parking for staff and students, with 840 spaces not exceeding 4 Levels.

- Total Project Budget\$33,205,037
- Funding SourceMeasure J
- Project Gross Square Footage.....260,000 GSF
- Estimated Construction Start.....Winter 2023
- Targeted CompletionSummer 2024



PROJECT STATUS REPORT — FULLERTON CAMPUS

NEW MAINTENANCE & OPERATION BUILDING PRE-PLANNING

Address	321 E. Chapman Ave. Fullerton, CA 92832
Project Manager	Oscar Saghieh Fullerton College
Architect	TBD
Project Delivery Method	TBD

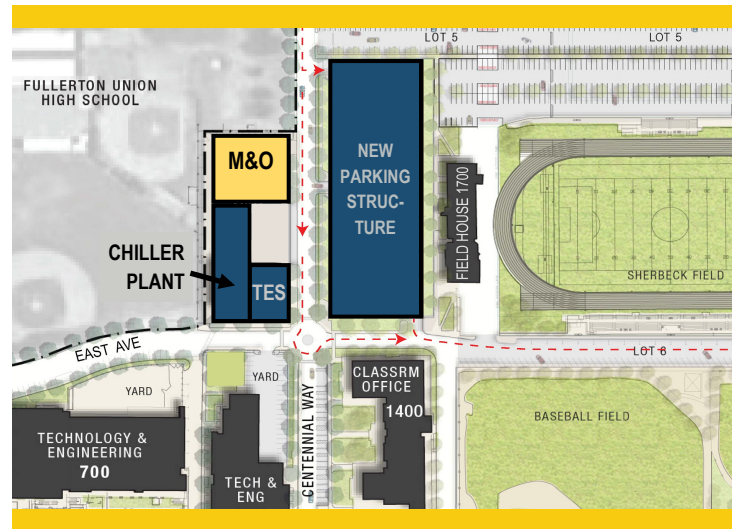

Project Overview

The New Maintenance and Operations building will centralize all M & O services into a single building located on the main campus. The building will include trade-specific workshops for maintenance, grounds, facilities, custodial personnel while improving response time and efficiencies by locating the building on the main campus adjacent to the central plant.

- Total Project Budget\$14,785,944
- Funding SourceMeasure J & Local Funds
 - Measure J\$7,072,378
 - Local Funds.....\$7,713,566
- Project Gross Square Footage.....22,300 GSF
- Estimated Construction Start.....Winter 2023
- Targeted CompletionSummer 2024



PROJECT STATUS REPORT — FULLERTON CAMPUS

UPDATE/IMPROVE INFRASTRUCTURE

VARIOUS STAGES

Address	321 E. Chapman Ave. Fullerton, CA 92832	Total Project Budget	\$31,370,654
		Total Budget Allocated	\$8,363,292
Number of Projects	2	Funding Source	Measure J

General Overview

Projects to address infrastructure improvements or upgrades throughout the Campus. Funds are allocated to projects as needs are identified.

IT Network Refresh Project Overview

BIDDING

Assessment of Campus data network infrastructure to identify necessary upgrades, and changes that will enable supporting future campus needs; specifically addressing wired, wireless, voice, and video networks. Design of a new network will account for the District’s needs specific to logical infrastructure for the next 10 years. Physical infrastructure will also account for the District’s needs for the next 20 years. The scope includes replacing network core switches, providing a more responsive support structure, preparing for cloud computing, and adaptation of voice over IP systems across the District.

- Project Budget\$8,000,000
- Funding SourceMeasure J & Capital Outlay Funds
- Project Delivery MethodCompetitive Bid - Best Value
- Architect.....Shandam Consulting
- Project ManagementDistrict IS / PlanNet Consulting
- Estimated Design Implementation Start.....Spring 2019
- Targeted CompletionWinter 2019



UPDATE/IMPROVE INFRASTRUCTURE

VARIOUS STAGES

Sewer Line Replacement to Buildings 300 & 500

AGENCY REVIEW

Design and construction for a new sewer line leading out of Building 300, and a new sewer line leading out of Building 500, as the existing lines are not functioning properly. The new sewer lines will travel from the existing buildings to the new saddle points of connection at the City of Fullerton’s sanitary sewer line, which is located on North Lemon Street.

- Project BudgetTBD
- Funding SourceMeasure J & Schedule Maintenance Funds
 - Measure J\$363,292
 - Scheduled Maintenance Funds\$91,013
- Project Delivery Method.....Design-Bid-Build
- Architect.....R2A Architects
- Estimated Construction Start.....Spring 2019
- Targeted CompletionSummer 2019



PROJECT STATUS REPORT — FULLERTON CAMPUS

UPDATES ON CAMPUS PROJECTS - FULLERTON COLLEGE

New Instructional Building

- RNT Architects submitted the 50% Construction Documents installment on January 25th for the Campus and District's review. A Meeting was held on February 1st, 2019 with the building user group to discuss the progression of the initial design and changes that have taken place since the 100% Design Development deliverable
- First phase of the New TES & Chilled Water Plant Expansion project is part of the criteria documents for this project. The first phase expansion of the Chilled Water Plant will only address additional demand derived from the operations of this new building in addition to the upcoming M&O Building.
- District IS and the campus are working on telecom cabling infrastructure scope of work not part of the contract with BN Builders, which entails the connection of the New Instructional Building to the two existing Main Distribution Frames (MDF) rooms in Buildings 3100 and 200 that will tie the new building to the Campus network. This scope of work was excluded from the Network Refresh Project and it did not form part of the Instructional Building RFP.
- BN Builders submitted a draft estimate of probable construction costs at 100% Design Development. A design contingency to address additional needs not anticipated during the RFP process remains at \$1.3M. A Design Option Log has also been updated to include enhancements to the project if budget allows. At the time of submittal, the log amounts to \$2.03M in additional scope inclusive of potential indirect costs. A finalized estimate was reconciled with O'Connor Construction Management and presented to the Campus Project team and District in early January 2019.
- The California Geological Survey concluded a satisfactory review of the geotechnical report produced for this project by Geotechnical Solutions, Inc. This is a crucial step in preparation of project submittal to DSA in March of 2019.

Renovate Buildings 300 & 500

- R2A Architecture submitted the 95% Construction Documents installment for District and Campus review on February 4th, 2018. Meetings for reviews with building user groups were scheduled for February 12th and 13th. MAAS conducted a constructability review for this drawings and specifications set. All review comments will be incorporated prior to submittal to DSA.
- MAAS has completed a preliminary constructability review of the 60% and 90% Construction Documents, with an evaluation of the 90% CD building specifications pending. An initial review submittal was provided to the project team on December 20th, with a final review submitted on the second week of January. The campus coordinated two sessions in late January for the review of all comments resulting from this constructability review with all related disciplines.
- Constructability Review comments produced by MAAS are being incorporated into the project drawings and specifications. Verification of integration of review remarks will take place this month.
- A tentative meeting with DSA is scheduled for February 25th, 2019. This meeting will serve as the



UPDATES ON CAMPUS PROJECTS - FULLERTON COLLEGE (Continued)

opportunity to discuss approaches to the 50% cost of replacement threshold limit placed by the state agency that requires seismic upgrades to the buildings. At the current design stage, the renovation both structures are below this threshold. However, these values might change once the project is bid in two years' time. R2A Architecture is working with HLCM for a detailed estimate for cost of building replacement to serve as the basis of this discussion.

- A series of potential deductive alternates have been developed in order to successfully manage the project budget and related threshold of 50% cost of building replacement noted earlier. Among the deductive alternates are the following: Roofing repairs options, exterior façade surface treatment, window material and refurbishment options, door material and refurbishment options, door hardware, elevator replacement or refurbishment, entrance feature refurbishment, flooring, and electrical equipment among a few others.
- The design team continues working with Fullerton Heritage on the review of the project scope of work and intended repairs to component of the buildings that are of historic significance. R2A Architecture will be following up with outstanding questions on exterior door replacement, light fixture refurbishment and reuse, and roof repairs. The College and Design teams will continue to keep Fullerton Heritage abreast of any design developments prior to submittal to DSA and project bidding.
- The stormwater drainage system in the vicinity to Building 500 is being evaluated for plausible redesign due to deficiencies and compliance with current building code. R2A Architecture in collaboration with David Evans & Associates are developing solutions to add as part of the existing scope of work for this project. Additional design cost and funding plausible partial funding from the State are being discussed.

New Parking Structure

- Evaluating Design-Build project delivery method.
- Project budget has been revised and increased to account for construction escalation costs at mid-point of construction. The project budget will be revised in the future close to the onset of project design.
- Construction will not start until the renovation of 300 & 500 Buildings has been completed.
- Target Construction Start in conjunction with M&O Building - Winter 2023.

New Maintenance & Operations Building

- Target Construction Start in conjunction with New Parking Structure - Winter 2023.
- Project budget has been revised and increased to account for construction escalation costs at mid-point of construction. The project budget will be revised in the future close to the onset of project design.



UPDATES ON CAMPUS PROJECTS - FULLERTON COLLEGE (Continued)

New TES & Chilled Water Plant Expansion

- First phase of New TES & Chilled Water Plant Expansion project is part of the criteria documents for the New Instructional Building. BN Builders, Inc. and Roesling Nakamura Terada (RNT) Architects, Inc. continues working alongside building user group members on the Design Development phase; as result of comments and design options, the design phase has not concluded.
- The building at the moment is envisioned to be mainly masonry with plaster exterior. It will have a flat roof with a parapet wall. Cooling towers are anticipated exposed within an enclosed area adjacent to the new building. There will be no need for fire sprinklers to be included in the space.
- The design-build team presented initial probable construction cost estimates for five options to the expansion of the central plant inclusive of three chillers and three cooling towers. Alternate options for the central plant are being evaluated, such as different building and yard arrangements for the expansion project, and the installation of air-cooled chillers in lieu of the combination of chillers and cooling towers.
- Project will proceed with its unique A number for DSA. RNT will be revising its fees from initially proposed amounts to reflect the need for other meetings at DSA in addition to those for the New Instructional Building.
- Design Development will proceed upon the selection of a design option. Additional fees for the design to be presented to the Board of Trustees in February 2019. The total construction cost change is anticipated at \$6.1 to \$8M in addition to the contracted amount.
- P2S Engineering has been tasked with a review of BSE Engineering study on Campus capacity needs with future building construction in consideration. Results and recommendations were submitted in mid-January 2019.

Update / Improve Infrastructure

IT Network Refresh Project

- District IS and Purchasing Departments posted the Request for Proposals (RFP) to the public on August 6th, 2018. The deadline for submitting questions regarding the RFP was August 31st. Answers were to be issued by the middle of September. Responses to the RFP were due on November 6th, 2018, and were followed by vendor presentations on November 15th, 2018. As the RFP evaluation process has been completed, approximately by the end of November 2018, interviews were conducted in December 2018. The goal is to have the selected vendor to start implementation of design during the first quarter of 2019.
- A vendor has been selected and a recommendation to award contract will be presented to the Board of Trustees in March 2019.
- The successful vendor is required to submit a project plan as part of their response to demonstrate how they would successfully implement the new architecture. The project plan should show the schedule, resources, and dependences including projected work effort, in



UPDATES ON CAMPUS PROJECTS - FULLERTON COLLEGE (Continued)

hours, for each milestone and subordinated to activities within each phase (i.e. Project, Phase, Milestone/Deliverable, Activity and Task). Submit hours and labor rates for staffing levels (i.e. Network Administration, Security, Architect) for each phase. The selection of an independent verification entity will be proceeding in the upcoming months.

- The design process is not funded by Bond Measures X or J. However, the construction and implementation phase will be bond-funded by Measure J. Equipment will be owner furnished, owner installed.

Sewer Line Replacement to Buildings 300 & 500

- Replacement for the sewer line connecting Buildings 300 & 500 to the city sewer on Lemon Dr. has been identified for necessary replacement. Extent of the scope of work will be addressed using Scheduled Maintenance funds for the design effort, and Measure J for construction costs. The designed replacement was submitted to the City of Fullerton for review. Initial feedback and markups were received and addressed. The project documents were resubmitted on January 11th, 2019 for final review.
- R2A Architecture completed the required traffic study in partnership with David Evans and Associates on January 9th, 2019. The existing purchase order for design services was amended by \$6,380 for the completion of the earlier study.
- Review of the traffic control and detour plan is being conducted by the City of Fullerton Traffic Division, anticipated completion is late February 2019.



AERIAL VIEW — ANAHEIM CAMPUS

CAMPUS PROJECTS



5th Floor CTE Laboratory
[Close-Out]



2nd Floor Room 215
[Close-Out]



10th Floor Buildout
[Construction]

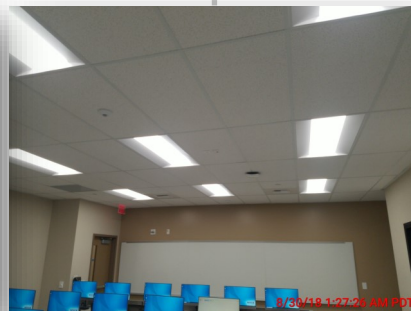

7th Floor Buildout
[Complete]

IT Network Refresh
(Throughout Campus)
[Bidding]



PROJECT STATUS REPORT — ANAHEIM CAMPUS

7th AND 10th FLOORS BUILDOUT

7th FLOOR—COMPLETE

10th FLOOR—CONSTRUCTION

Address	1830 W. Romneya Dr. Anaheim, CA 92801
Project Manager	Rick Williams NOCCCD
Architect	R ² A Architecture
General Contractor	Paul C. Miller Construction Co.
Project Gross Square Footage	19,630 GSF (7th & 10th)
Project Delivery Method	Design - Bid - Build
DSA Application A#	04-115733



Project Overview

The 7th floor remodels will accommodate NOCE’s needs for assessment centers, while the 10th floor will accommodate the District’s Vice Chancellor, Educational Services & Technology Department.

Budget & Construction Costs

- Funding Sources..... Measures X & J
- Total Project Budget (Est.) \$6,038,776
 - Measure X (Est.)..... \$3,887,417
 - Measure J (Est.) \$2,151,359
- Construction Cost..... \$3,744,087
 - Contracted Amount..... \$3,574,000
 - Allowance Used \$0
 - Authorized Change Orders \$170,087

Schedule

- Design Start May 31, 2016
- Construction Start Dec. 18, 2017
- Targeted Substantial Completion Feb. 2019
- Targeted Construction Completion Apr. 2019
- Targeted Occupancy Apr. 2019



PROJECT STATUS REPORT — ANAHEIM CAMPUS

5th FLOOR CTE AND 2ND FLOOR ROOM 215 CLOSE-OUT

Address	1830 W. Romneya Dr. Anaheim, CA 92801
Project Manager	Cora Baldovino NOCCCD
Architect	R²A Architecture
General Contractor	Interlog Construction
Project Gross Square Footage	1,765 GSF (5th & 2nd)
Project Delivery Method	Design - Bid - Build
DSA Application A#	04-116694

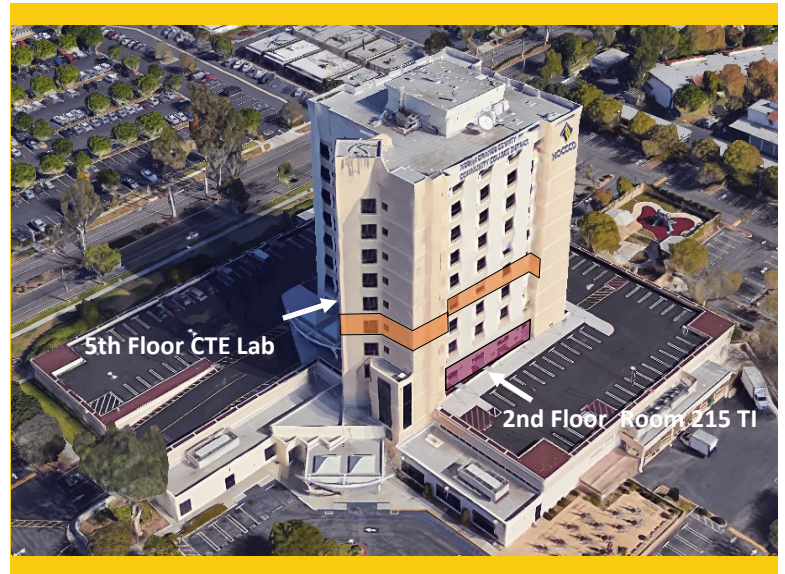

Project Overview

The 5th floor area remodels accommodates a new laboratory and instructional space for the Career Technical Education program. The 2nd floor area tenant improvements converted Testing Room 215 into two new offices being used by Student Success and Support Program (SSSP) Counseling.

Budget & Construction Costs

- Funding Sources..... Measure J
- Total Project Budget (Est.) \$636,256
 - Measure J (Est.) \$636,256
- Construction Cost \$433,604
 - Contracted Amount..... \$410,000
 - Allowance Used \$24,048
 - Authorized Change Orders \$23,605

Schedule

- Design Start Jul. 19, 2017
- Construction Start Apr. 17, 2018
- Substantial Completion..... Aug. 23, 2018
- Construction Completion..... Sep. 17, 2018
- Occupancy..... Dec. 11, 2018



PROJECT STATUS REPORT – ANAHEIM CAMPUS

UPDATE/IMPROVE INFRASTRUCTURE

BIDDING

Address	1830 W. Romneya Dr. Anaheim, CA 92801	Total Project Budget	\$1,766,540
		Total Budget Allocated	\$1,000,000
Number of Projects	1	Funding Source	Measure J

General Overview

Projects to address infrastructure improvements or upgrades throughout the Campus. Funds are allocated to projects as needs are identified.

IT Network Refresh Project Overview

BIDDING

Assessment of Campus data network infrastructure to identify necessary upgrades, and changes that will enable supporting future campus needs; specifically addressing wired, wireless, voice, and video networks. Design of a new network will account for the District’s needs specific to logical infrastructure for the next 10 years. Physical infrastructure will also account for the District’s needs for the next 20 years. The scope includes replacing network core switches, providing a more responsive support structure, preparing for cloud computing, and adaptation of voice over IP systems across the District.

- Project Budget\$1,000,000
- Funding SourceMeasure J & Capital Outlay Funds
- Project Delivery MethodCompetitive Bid - Best Value
- Architect.....Shandam Consulting
- Project ManagementDistrict IS / PlanNet Consulting
- Estimated Design Implementation Start.....Spring 2019
- Targeted CompletionWinter 2019



PROJECT STATUS REPORT – ANAHEIM CAMPUS

UPDATES ON CAMPUS PROJECTS - ANAHEIM CAMPUS

7th and 10th Floors Buildout

- Paul C Miller Construction started construction work on phase II of the project on July 23rd, 2018. Wall framing, rough-in installation of electrical, plumbing, and HVAC throughout the floor was completed on schedule. Work is proceeding with ceiling T-bar and finishes. General contractor is currently working on a regular schedule as construction activities are not disruptive to building users.
- Punch List walks will take place later this month. Construction of phase two of the project is anticipated to conclude in March 2019
- CBRE/Heery is working with Paul C. Miller in project commissioning efforts for the 7th and 10th Floors tenant improvements. Periodic visits have taken place during the installation of the mechanical and ventilation components of the project. CBRE/Heery also began retro-commissioning investigations for the Anaheim Tower.
- The Board of Trustees approved in January Change Orders 6 to 8 for a net change of \$170,087.39 to Paul C. Miller for a new contract amount of \$3,744,087.39. There are eleven outstanding PCOs totaling \$38,262 that are still in review or negotiation.

5th Floor CTE and 2nd Floor Room 215

- Interlog Construction concluded construction activities on the 5th floor CTE laboratory and 2nd floor counseling offices. Punch list items were completed at the end of September.
- Notice of Completion (NOC) was submitted to the Board of Trustees on December 11th, 2018. Final retention payment is being processed including the release of retention to the general contractor.
- A deductive change order will be processed to reduce the contracted amount for construction on any unused allowance balances with Interlog Construction.

Update / Improve Infrastructure

IT Network Refresh Project

- District IS and Purchasing Departments posted the Request for Proposals (RFP) to the public on August 6th, 2018. The deadline for submitting questions regarding the RFP was August 31st. Answers were to be issued by the middle of September. Responses to the RFP were due on November 6th, 2018, and were followed by vendor presentations on November 15th, 2018. As the RFP evaluation process has been completed, approximately by the end of November 2018, interviews were conducted in December 2018. The goal is to have the selected vendor to start implementation of design during the first quarter of 2019.
- A vendor has been selected and a recommendation to award contract will be presented to the Board of Trustees in March 2019.
- The successful vendor is required to submit a project plan as part of their response to demonstrate how they would successfully implement the new architecture. The project plan should show the schedule, resources, and dependences including projected work effort, in



PROJECT STATUS REPORT – ANAHEIM CAMPUS

UPDATES ON CAMPUS PROJECTS - Anaheim COLLEGE (Continued)

hours, for each milestone and subordinated to activities within each phase (i.e. Project, Phase, Milestone/Deliverable, Activity and Task). Submit hours and labor rates for staffing levels (i.e. Network Administration, Security, Architect) for each phase. The selection of an independent verification entity will be proceeding in the upcoming months.

- The design process is not funded by Bond Measures X or J. However, the construction and implementation phase will be bond-funded by Measure J. Equipment will be owner furnished, owner installed.



FINANCIAL REVIEW

- Capital Projects Update
- Estimated Project Budgets
- 90-Day Look Ahead Schedule



CAPITAL PROJECT UPDATES

**North Orange County Community College District
Measure J
Capital Projects Update
January 31, 2019**

Bond Authorization:

Bond Authorization	574,000,000	100.00%
Bonds Sold - Series A	100,000,000	17.42%
Available Principal Amount of Bonds	474,000,000	82.58%

Bond Funding Sources (Budget):

		Actual Received	Remaining Balance
Bond Authorization	574,000,000	100,000,000	474,000,000
Estimated Net Interest Earnings	4,000,000	2,815,042	1,184,958
Totals	578,000,000	102,815,042	475,184,958

Cost Status:

Campus	Total Budget	%	Actual Expenses to Date	Remaining Balance
Anaheim Campus	17,007,800	2.94%	930,865	16,076,935
Cypress Campus	225,921,200	39.11%	8,221,107	217,700,093
Fullerton Campus	311,126,400	53.83%	3,906,114	307,220,286
District Expenses				
• Program Management	20,000,000	3.46%	2,601,610	17,398,390
• Bond Issuance Cost	3,544,600	0.61%	557,977	2,986,623
• Other Bond Expense	400,000	0.07%	148,607	251,393
Totals	578,000,000	100.00%	16,366,280	561,633,720



Intentionally Left Blank

ESTIMATED PROJECT BUDGETS

CYPRESS CAMPUS

CURRENT PROJECTS

ESTIMATED PROJECT BUDGET—CYPRESS

CURRENT PROJECTS	Measure J Budget	Measure J Expenses	Balance
New Science, Engineering, and Mathematics Building	\$ 94,783,786	\$ 4,727,706	\$ 90,056,080
New Veterans' Resource Center & Student Activities Center Expansion	\$ 13,500,000	\$ 1,102,538	\$ 12,397,462
Veterans' Memorial Bridge and Tribute Garden	\$ 100,800	\$ -	\$ 100,800
Fine Arts Capital Improvement	\$ 16,764,338	\$ -	\$ 16,764,338
Update/Improve Infrastructure	\$ 14,408,894	\$ -	\$ 14,408,894
Update/Improve Infrastructure (New SEM)	\$ 2,854,576	\$ -	\$ 2,854,576
Update/Improve Infrastructure (IT)	\$ 6,000,000	\$ -	\$ 6,000,000
Update/Improve Infrastructure (VRC/SAC)	\$ 1,074,362		\$ 1,074,362
Planning (Non Project Specific)	\$ 520,000	\$ 138,482	\$ 381,518
Library-Learning Resource Center Expansion	\$ 15,000,000	\$ 38,665	\$ 14,961,335
Swing Space Projects	\$ 3,236,521	\$ 2,061,294	\$ 1,175,227
Mass Communications & Security Systems Upgrade	\$ 4,079,170	\$ -	\$ 4,079,170
Mass Communications & Security Systems Upgrade (New SEM)	\$ 310,883	\$ -	\$ 310,883
Mass Communications & Security Systems Upgrade (Safety Film)	\$ 145,774	\$ 145,772	\$ 2
Mass Communications & Security Systems Upgrade (Door Replacement)	\$ 50,671	\$ 6,650	\$ 44,021
Mass Communications & Security Systems Upgrade (VRC/SAC)	\$ 62,002		\$ 62,002
Pool Restoration and Upgrade	\$ 4,876,000	\$ -	\$ 4,876,000
Gym I/Gym II Restoration and Restrooms	\$ 4,837,500	\$ -	\$ 4,837,500
Gateway Phase 1	\$ 5,810,000	\$ -	\$ 5,810,000
Under Piazza & Stairwell Restoration	\$ 1,963,800	\$ -	\$ 1,963,800
Tech I/Tech III Capital Improvements	\$ 27,645,342	\$ -	\$ 27,645,342
Athletic Field Realignment/Entry Revisions/Parking Lot Improvements	\$ 7,896,781	\$ -	\$ 7,896,781
SUB TOTAL	\$ 225,921,200	\$ 8,221,107	\$ 217,700,093



ENCUMBRANCES OVER \$10,000

CYPRESS CAMPUS - New Encumbrances (Nov. 2018 - Feb. 2019)

No Purchase Orders Over \$10,000 have been issued for Cypress Campus since November 1st, 2019



ESTIMATED PROJECT BUDGETS

FULLERTON CAMPUS

CURRENT PROJECTS

ESTIMATED PROJECT BUDGET—FULLERTON

CURRENT PROJECTS	Measure J Budget	Measure J Expenses	Balance
New Instructional Building	\$ 54,000,000	\$ 2,688,641	\$ 51,311,359
Renovate Buildings 300 & 500	\$ 20,482,000	\$ 858,906	\$ 19,623,094
New TES & Chilled Water Plant Expansion - Phase II	\$ 10,139,524	\$ -	\$ 10,139,524
Chiller Plant Expansion (New Instructional Bldg) Phase I	\$ 2,000,000	\$ 148,806	\$ 1,851,194
Update/Improve Infrastructure	\$ 23,007,362	\$ -	\$ 23,007,362
Update/Improve Infrastructure (IT)	\$ 8,000,000	\$ -	\$ 8,000,000
Update/Improve Infrastructure (Bldg 300-500 Sewer Line)	\$ 363,292		\$ 363,292
Planning (Non Project Specific)	\$ 595,000	\$ 209,761	\$ 385,239
New Parking Structure	\$ 33,205,037	\$ -	\$ 33,205,037
New M & O Building	\$ 7,072,378	\$ -	\$ 7,072,378
New Horticulture/Lab School/STEM Lab	\$ 34,648,145	\$ -	\$ 34,648,145
New Performing Arts Complex—Phase 1	\$ 16,133,000	\$ -	\$ 16,133,000
New Performing Arts Complex—Phase 2	\$ 12,409,153	\$ -	\$ 12,409,153
New Welcome Center & Lot C West	\$ 36,564,000	\$ -	\$ 36,564,000
Demolish Buildings 1100, 1300 and 2300	\$ 2,182,000	\$ -	\$ 2,182,000
Demolish Building 2000	\$ 1,108,000	\$ -	\$ 1,108,000
Renovate Building 600	\$ 6,739,100	\$ -	\$ 6,739,100
Renovate Building 840 Campus Services	\$ 7,878,400	\$ -	\$ 7,878,400
Renovate Health Center	\$ 1,328,800	\$ -	\$ 1,328,800
Renovate Building 1000 Fine Arts Gallery	\$ 5,043,010	\$ -	\$ 5,043,010
Renovate Faculty Lounge & Offices	\$ 6,212,250	\$ -	\$ 6,212,250
Renovate Wellness Center	\$ 2,534,400	\$ -	\$ 2,534,400
Landscape & Hardscape Improvements	\$ 3,840,000	\$ -	\$ 3,840,000
Renovate Building 3100	\$ 2,639,340	\$ -	\$ 2,639,340
Demolish Building 1901-04, 1956-60, 3000	\$ 1,333,000	\$ -	\$ 1,333,000
Parking Lot Improvements at Building 3000	\$ 1,999,500	\$ -	\$ 1,999,500
Renovate Building 2100	\$ 8,277,500	\$ -	\$ 8,277,500
Demolish Buildings 2200 & 3104	\$ 1,392,209	\$ -	\$ 1,392,209
SUB TOTAL	\$311,126,400	\$3,906,114	\$307,220,286



ENCUMBRANCES OVER \$10,000

FULLERTON CAMPUS - New Encumbrances (Nov. 2018 - Feb. 2019)

Project	Vendor	Purchase Order No.	Purchase Order Amount	Scope of Work
New Instructional Building	Division of the State Architect (DSA)	P0130003	\$496,171.85	Plan check fees for New Instructional Building construction documents
Renovate Buildings 300 and 500	Division of the State Architect (DSA)	P0130002	\$269,696.06	Plan check fees for Renovation of Buildings 300 and 500 construction documents
New TES & Chilled Water Plant Expansion	P2S Engineering Inc.	P0129501	\$12,500.00	Peer review of Chiller Plant Study



ESTIMATED PROJECT BUDGETS

ANAHEIM CAMPUS

CURRENT PROJECTS

ESTIMATED PROJECT BUDGET—ANAHEIM

CURRENT PROJECTS	Measure J Budget	Measure J Expenses	Balance
Reactivate 1st Floor Warehouse Areas for Storage	\$ 202,000	\$ -	\$ 202,000
7th and 10th Floors Buildout	\$ 2,151,359	\$ 324,803	\$ 1,826,556
5th Floor CTE & 2nd Floor Room 215	\$ 636,256	\$ 596,587	\$ 39,669
Repurpose Childcare	\$ 1,246,200	\$ -	\$ 1,246,200
Second Floor Tenant Improvements	\$ 813,000	\$ -	\$ 813,000
Outdoor Patio Remodel	\$ 1,382,500	\$ -	\$ 1,382,500
Fourth Floor Improvements	\$ 218,000	\$ -	\$ 218,000
Update/Improve Infrastructure	\$ 766,540	\$ -	\$ 766,540
Update/Improve Infrastructure (IT)	\$ 1,000,000	\$ -	\$ 1,000,000
Planning (Non Project Specific)	\$ 440,000	\$ 9,475	\$ 430,525
Student Lounge	\$ 222,200	\$ -	\$ 222,200
Upper Parking Lot Remodel	\$ 1,104,500	\$ -	\$ 1,104,500
Develop Interior and Exterior Signage	\$ 313,800	\$ -	\$ 313,800
Enliven Corridors/Develop Areas for Student Collaboration	\$ 888,800	\$ -	\$ 888,800
Develop South Entry Plaza	\$ 816,800	\$ -	\$ 816,800
Develop East Entry Plaza	\$ 413,200	\$ -	\$ 413,200
Remove Planters/Create Japanese Rock Garden	\$ 309,901	\$ -	\$ 309,901
Reconfigure Parking Lots	\$ 2,099,000	\$ -	\$ 2,099,000
Develop Drop-Off Plaza at Romneya Drive	\$ 1,069,000	\$ -	\$ 1,069,000
Develop Intersection at Romneya & Coronet	\$ 914,744	\$ -	\$ 914,744
SUB TOTAL	\$ 17,007,800	\$ 930,865	\$ 16,076,935



ENCUMBRANCES OVER \$10,000

ANAHEIM CAMPUS - New Encumbrances (Nov. 2018 - Feb. 2019)

Project	Vendor	Purchase Order	Purchase Order	Scope of Work
7th and 10th Floor Buildout	CBRE Heery Inc.	P0122391	\$31,562.00	Commissioning services for the 7th and 10th Floors
7th and 10th Floor Buildout	GST	P0128943	\$59,336.46	Installation of AV equipment in the ESL Lab
7th and 10th Floor Buildout	CDW Government	P0129497	\$32,153.41	FF&E 10th Floor



ESTIMATED PROJECT BUDGETS

DISTRICT

ESTIMATED PROJECT BUDGET—DISTRICT

DISRICT WIDE EXPENSE	Measure J Budget	Measure J Expenses	Balance
Program Management Fees	\$ 20,000,000	\$ 2,601,610	\$ 17,398,390
Bond Issuance Cost	\$ 3,544,600	\$ 557,977	\$ 2,986,623
Other	\$ 400,000	\$ 148,607	\$ 251,393
SUB TOTAL	\$ 23,944,600	\$ 3,308,194	\$ 20,636,406



ENCUMBRANCES OVER \$10,000

DISTRICT - New Encumbrances (Nov. 2018 - Feb. 2019)

Vendor	Purchase Order No.	Purchase Order Amount	Scope of Work
MAAS Companies	P0106630	\$2,391,213.00	2-Year Contract Extension for Program Management Services



NORTH ORANGE COMMUNITY COLLEGE DISTRICT
CYPRESS - FULLERTON - ANAHEIM (NOCE)
90-DAY LOOK AHEAD SCHEDULE
 (02-01-19 TO 04-30-19)

	February					March					April					Comments
	5	12	19	26		5	12	19	26		2	9	16	23	30	
GENERAL																
NOCCCD Board Meetings																
COC Meetings																
Bond Program Management Team Mtgs.																March 6th
Anaheim NOCE - Campus Coordination Meeting																April Meeting TBD
Cypress - Campus Coordination Meeting																No Meetings Scheduled
Fullerton - Campus Coordination Meeting																No Meetings Scheduled
PLANNING																
DESIGN PHASE																
FULLERTON																
Working Drawings for Renovate Buildings 300 & 500																Complete
Construction Documents for Renovate Buildings 300 & 500																Complete
New Instructional Building Construction Documents																In Progress - Completion Anticipated in Mar. 2019
Phase I Central Plant Expansion Design Development																In Progress - Completion Anticipated in Feb. 2019
Phase I Central Plant Expansion Construction Documents																To Start in mid-February 2019
DSA PHASE & AGENCY REVIEW																
CYPRESS																
Deferred Approvals for New VRC/SAC																Submittal Pending
Deferred Approvals for New SEM																Submittal Pending
Review of Fire Sprinklers Addendum for New VRC/SAC																Complete
FULLERTON																
Review of Buildings 300 & 500 Construction Documents																Anticipated Submittal to DSA in March 2019
Review of New Instructional Bldg. Construction Documents																Anticipated Submittal to DSA in April 2019
Review of Sewer Line Replacement for Buildings 300 & 500 *																Pending Final Review & Approval
PRE-CONSTRUCTION PHASE																
CYPRESS																
Bidding for Trade Contractors New SEM & VRC/SAC																Complete
GMP Negotiations for New SEM & VRC/SAC																Complete
FULLERTON																
Bidding of Sewer Line Replacement for Buildings 300 & 500																To Start Upon Approval of Construction Drawings
INFORMATION TECHNOLOGY NETWORK REFRESH																
Vendor Selection Network Refresh Design *																To be completed by Jan. 22, 2019
CONSTRUCTION PHASE																
CYPRESS																
New SEM & Assoc. Mass Comm and Infra. Construction																Groundbreaking Feb. 8, 2019
New VRC/SAC & Assoc. Mass Comm and Infra. Construction																Anticipated Start - Feb. 13, 2019; Groundbreaking Mar. '19
Safety Film and Door Replacement Projects																Complete
ANAHEIM (NOCE)																
7th and 10th Floors Buildout Phase II Construction																In Progress - Completion in March 2019
CLOSE-OUT PHASE																
CYPRESS																
Gym II Reconfiguration for SAC Swing Space Close-Out																In Progress
Lots 4 & 5 Parking Lot Realignment																In Progress
ANAHEIM (NOCE)																
10th Floor Move Management																To Start Upon Completion of Construction Activities
7th & 10nd Floors Close-Out																To Start Upon Completion of Move Management Activities
5th & 2nd Floors Move Management & Close-Out																In Progress

* Non-Measure J expenditure activities

Intentionally Left Blank

March 2019

Citizens' Oversight Committee

COCC

Measure J Bond Programs



1830 W. Romney Dr., Building B., Anaheim, CA 92801