

April 2020



# Measure J Bond Program

CAPITAL PROJECTS REPORT  
to the

Board of Trustees

MAAS

**Intentionally Left Blank**

# TABLE OF CONTENTS

## Financial Review - Estimated Project Budgets

<i>Measure J Summary</i> .....	3
<i>Project Allocations</i> .....	4-7
<i>Finance Report</i>	
Cypress .....	9
Fullerton .....	25
Anaheim .....	37

## Project Status Reports

<i>Cypress Campus</i>	
New Science, Engineering, and Mathematics Building .....	10-11
New Veterans' Resource Center & Student Activities Center Expansion .....	12-13
Veterans' Memorial Bridge, Plaza, & Tribute Garden .....	14
Pond Refurbishment.....	15
Fine Arts Capital Improvements .....	16
Swing Space Projects .....	17
Update / Improve Infrastructure.....	18-19
Mass Communication & Security Systems Upgrade .....	20
Updates on Campus Projects - Cypress College .....	21-23
<i>Fullerton Campus</i>	
New Instructional Building .....	26
Central Plant Replacement & Expansion.....	27
Renovate Buildings 300 & 500.....	28
New Parking Structure.....	29
New Maintenance & Operation Building .....	30
Update / Improve Infrastructure.....	31-32
Updates on Campus Projects - Fullerton College .....	33-34
<i>Anaheim Campus</i>	
7th and 10th Floors Buildout.....	38
Update / Improve Infrastructure.....	39
Updates on Campus Projects - Anaheim Campus .....	40

## Current Projects

Key Milestones and Decisions to the Board of Trustees .....	42
30-Day Look Ahead Schedule.....	43-44
90-Day Look Ahead Schedule.....	45

## Completed Projects

Cypress College .....	48
NOCE - Anaheim Campus & District Offices.....	49

**Intentionally Left Blank**

# FINANCIAL REVIEW

## ESTIMATED PROJECT BUDGETS

### Measure J Summary

### Campus Project Allocation Budgets

- Cypress
- Fullerton
- Anaheim
- District



**Intentionally Left Blank**

# MEASURE J SUMMARY

## North Orange County Community College District Measure J Summary March 31, 2020

### Bond Authorization:

Bond Authorization:	574,000,000	100.00%
Bonds Sold - Series A + B	250,000,000	43.55%
Available Principal Amount of Bonds:	<b>324,000,000</b>	<b>56.45%</b>

### Bond Funding Sources

		Actual Received	Remaining Balance
Bond Authorization:	574,000,000	250,000,000	324,000,000
Estimated Interest Earnings:	8,000,000	7,121,804	878,196
<b>Totals:</b>	<b>582,000,000</b>	<b>257,121,804</b>	<b>324,878,196</b>

### Cost Status:

Campus	Bond Funds	Bond Funds %	Other Funds	Total Budget	Total Project Funds %	Actual Expenses to Date 03/31/2020	Remaining Balance
Anaheim Campus	20,607,800	3.54%	8,832,917	29,440,717	4.28%	6,809,839	22,630,878
Cypress Campus	225,921,200	38.82%	45,815,017	271,736,217	39.46%	43,970,281	227,765,936
Fullerton Campus	311,126,400	53.46%	51,981,166	363,107,566	52.73%	7,147,490	355,960,076
District Expenses:							
Program Management	20,000,000	3.44%	-	20,000,000	2.90%	3,917,100	16,082,900
Bond Issuance Cost	3,544,600	0.61%	-	3,544,600	0.51%	1,301,760	2,242,840
Other Bond Expense	800,000	0.14%	-	800,000	0.12%	260,852	539,148
<b>Totals</b>	<b>582,000,000</b>	<b>100.00%</b>	<b>106,629,100</b>	<b>688,629,100</b>	<b>100.00%</b>	<b>63,407,322</b>	<b>625,221,778</b>





CAMPUS PROJECT ALLOCATION BUDGETS REPORT

3/31/2020

CYPRESS CAMPUS

Project	Measure J Bond		Variance	Measure J Bond		TOTAL BUDGET	ACTUAL EXPENSE	Balance
	2/29/2020	Revised Budget		3/31/2020	Revised Budget			
New Science, Engineering, and Mathematics Building	94,322,272	-	-	94,322,272	3,000,000	97,322,272	30,968,476	66,353,796
New Veterans' Resource Center & Student Activities Center Expansion	13,500,000	-	-	13,500,000	-	13,500,000	6,094,155	7,405,845
Veterans' Memorial Bridge, Plaza, and Tribute Garden	100,800	-	-	100,800	1,500,000	1,600,800	451,685	1,149,115
Pond Refurbishment	-	-	-	-	682,017	682,017	468,262	213,755
Fine Arts Capital Improvement	16,764,338	-	-	16,764,338	18,133,000	34,897,338	-	34,897,338
Update/Improve Infrastructure	14,480,268	(32,207)	1&2	14,448,061	-	14,448,061	-	14,448,061
Update/Improve Infrastructure (New SEM)	2,801,641	-	-	2,801,641	-	2,801,641	2,269,178	532,463
Update/Improve Infrastructure (IT)	6,000,000	-	-	6,000,000	-	6,000,000	192,988	5,807,012
Update/Improve Infrastructure (VRC/SAC)	1,055,923	-	-	1,055,923	-	1,055,923	910,224	145,699
Update/Improve Infrastructure (Central Plant Enhancements)	-	-	1&2	32,207	-	32,207	-	32,207
Planning (Non Project Specific)	520,000	-	-	520,000	-	520,000	150,807	369,193
Library-Learning Resource Center Expansion	15,000,000	-	-	15,000,000	-	15,000,000	38,665	14,961,335
Swing Space Projects	3,236,521	-	-	3,236,521	-	3,236,521	2,202,518	1,034,003
Mass Communications & Security Systems Upgrade	4,085,557	(58,670)	3	4,026,887	-	4,026,887	-	4,026,887
Mass Communications & Security Systems Upgrade (New SEM)	305,333	-	-	305,333	-	305,333	13,882	291,451
Mass Communications & Security Systems Upgrade (Safety Film)	145,774	-	-	145,774	-	145,774	145,772	2
Mass Communications & Security Systems Upgrade (Door Replacement)	50,898	-	-	50,898	-	50,898	50,898	-
Mass Communications & Security Systems Upgrade (VRC/SAC)	60,938	-	-	60,938	-	60,938	12,771	48,167
Mass Communications & Security Systems Upgrade (Cameras)	-	-	3	58,670	-	58,670	-	58,670
Pool Restoration and Upgrade	4,876,000	-	-	4,876,000	-	4,876,000	-	4,876,000
Gym I/Gym II Restoration and Restrooms	4,837,500	-	-	4,837,500	-	4,837,500	-	4,837,500
Gateway Phase I	5,810,000	-	-	5,810,000	-	5,810,000	-	5,810,000
Under Piazza & Stairwell Restoration	1,963,800	-	-	1,963,800	-	1,963,800	-	1,963,800
Tech I/Tech III Capital Improvements	27,645,342	-	-	27,645,342	22,500,000	50,145,342	-	50,145,342
Athletic Field Realignment/Entry Revisions/Parking Lot Improvements	8,358,295	-	-	8,358,295	-	8,358,295	-	8,358,295
Parking Structure	-	-	-	-	-	-	-	-
<b>Subtotal- Cypress Campus</b>	<b>225,921,200</b>	<b>(90,877)</b>		<b>225,921,200</b>	<b>45,815,017</b>	<b>271,736,217</b>	<b>43,970,281</b>	<b>227,765,936</b>

General Notes:

- DMG Corporation (Bronze Impellers) - \$15,707,21 - PO to be revised from SEM Fund 49553 to Update/Improve Utilities Fund 49559.
- P2S Engineering (Engineering services - Chilled Water Booster Pumps) - \$16,500. - PO to be revised from SEM Fund 49553 to Update/Improve Utilities Fund 49559. Transfer of expenditures in the amount of \$13,406. is required from 49553 to Fund 49559.
- GuidepostSolutions, LLC (Security Assessment) - \$58,670.





**CAMPUS PROJECT ALLOCATION BUDGETS REPORT**  
**3/31/2020**

**FULLERTON CAMPUS**

Project	Measure J Bond		Variance	Measure J Bond		Other Funding	TOTAL BUDGET ACTUAL EXPENSE	Balance
	2/29/2020	3/31/2020		2/29/2020	3/31/2020			
New Instructional Building	53,588,031	53,588,031	-	53,588,031	-	-	53,588,031	49,445,637
Renovate 300 & 500 Buildings	20,482,000	20,482,000	-	20,482,000	15,348,000	-	35,830,000	34,166,458
Central Plant Replacement & Expansion	10,600,000	10,600,000	-	10,600,000	-	-	10,600,000	9,571,562
New Thermal Energy Storage (TES)	10,139,524	10,139,524	-	10,139,524	-	-	10,139,524	10,139,524
Update/Improve Infrastructure	23,007,362	23,007,362	-	23,007,362	-	-	23,007,362	23,007,362
Update/Improve Infrastructure (IT)	8,000,000	8,000,000	-	8,000,000	-	-	8,000,000	7,986,294
Update/Improve Infrastructure (Bldg 300-500 Sewer Line)	363,292	363,292	-	363,292	91,013	-	454,305	386,592
Planning (Non Project Specific)	595,000	595,000	-	595,000	-	-	595,000	363,303
New Parking Structure	33,205,037	33,205,037	-	33,205,037	-	-	33,205,037	33,205,037
New M&O Building	6,758,944	6,758,944	-	6,758,944	8,000,000	-	14,758,944	14,758,944
New Horticulture/Lab School/STEM Lab	34,648,145	34,648,145	-	34,648,145	-	-	34,648,145	34,648,145
New Performing Arts Complex –Phase I	16,133,000	16,133,000	-	16,133,000	16,133,000	-	32,266,000	32,266,000
New Performing Arts Complex –Phase 2	12,409,153	12,409,153	-	12,409,153	12,409,153	-	24,818,306	24,818,306
New Welcome Center & Lot C West	37,353,872	37,353,872	-	37,353,872	-	-	37,353,872	37,353,872
Demolish Buildings 1100, 1300 and 2300	2,182,000	2,182,000	-	2,182,000	-	-	2,182,000	2,182,000
Demolish Building 2000	1,108,000	1,108,000	-	1,108,000	-	-	1,108,000	1,108,000
Renovate Building 600	3,117,641	3,117,641	-	3,117,641	-	-	3,117,641	3,117,641
Renovate Building 840 Campus Services	7,878,400	7,878,400	-	7,878,400	-	-	7,878,400	7,878,400
Renovate Health Center	1,328,800	1,328,800	-	1,328,800	-	-	1,328,800	1,328,800
Renovate Faculty Lounge & Offices	6,212,250	6,212,250	-	6,212,250	-	-	6,212,250	6,212,250
Renovate Wellness Center	2,534,400	2,534,400	-	2,534,400	-	-	2,534,400	2,534,400
Landscape & Hardscape Improvements	3,840,000	3,840,000	-	3,840,000	-	-	3,840,000	3,840,000
Renovate Building 3100	2,639,340	2,639,340	-	2,639,340	-	-	2,639,340	2,639,340
Demolish Buildings 1901-04, 1956-60, 3000	1,333,000	1,333,000	-	1,333,000	-	-	1,333,000	1,333,000
Parking Lot Improvements at Building 3000	1,999,500	1,999,500	-	1,999,500	-	-	1,999,500	1,999,500
Renovate Building 2100	8,277,500	8,277,500	-	8,277,500	-	-	8,277,500	8,277,500
Demolish Buildings 2200 & 3104	1,392,209	1,392,209	-	1,392,209	-	-	1,392,209	1,392,209
Renovate Building 100	-	-	-	-	-	-	-	-
Renovate Building 1000 Fine Arts Gallery	-	-	-	-	-	-	-	-
Chapman Newell Instructional Building	-	-	-	-	-	-	-	-
<b>Subtotal- Fullerton Campus</b>	<b>311,126,400</b>	<b>311,126,400</b>	<b>-</b>	<b>311,126,400</b>	<b>51,981,166</b>	<b>-</b>	<b>363,107,566</b>	<b>355,960,076</b>

General Notes:



**CAMPUS PROJECT ALLOCATION BUDGETS REPORT**  
**3/31/2020**

**ANAHEIM CAMPUS**

Project	Measure J Bond	Measure J Bond	Variance	Measure J Bond		TOTAL BUDGET	ACTUAL EXPENSE	Balance
	2/29/2020	3/31/2020		Revised Budget	Other Funding			
Reactivate 1 <sup>st</sup> Floor Warehouse Areas for Storage	202,000	202,000	-	1,050,000	1,252,000	788,583	463,417	
7 <sup>th</sup> and 10 <sup>th</sup> Floors Buildout	2,151,359	2,151,359	-	3,887,417	6,038,776	5,172,345	866,431	
5 <sup>th</sup> Floor CTE & 2 <sup>nd</sup> Floor Room 215	640,736	640,736	-		640,736	640,736	-	
Repurpose Childcare	1,246,200	1,246,200	-		1,246,200		1,246,200	
Second Floor Tenant Improvements	813,000	813,000	-		813,000		813,000	
Outdoor Patio Remodel	1,382,500	1,382,500	-		1,382,500		1,382,500	
Fourth Floor Improvements	218,000	218,000	-		218,000		218,000	
Update/Improve Infrastructure	766,540	766,540	-		766,540		766,540	
Update/Improve Infrastructure (IT)	1,000,000	1,000,000	-		1,000,000	198,700	801,300	
Planning (Non Project Specific)	440,000	440,000	-		440,000	9,475	430,525	
Student Lounge	217,720	217,720	-		217,720		217,720	
Upper Deck Parking Lot Remodel	1,104,500	1,104,500	-	3,895,500	5,000,000		5,000,000	
Develop Interior and Exterior Signage	313,800	313,800	-		313,800		313,800	
Enliven Corridors/Develop Areas for Student Collaboration	888,800	888,800	-		888,800		888,800	
Develop South Entry Plaza	816,800	816,800	-		816,800		816,800	
Develop East Entry Plaza	413,200	413,200	-		413,200		413,200	
Remove Planters/Create Japanese Rock Garden	309,901	309,901	-		309,901		309,901	
Reconfigure Parking Lots	2,099,000	2,099,000	-		2,099,000		2,099,000	
Develop Drop-Off Plaza at Romneya Drive	1,069,000	1,069,000	-		1,069,000		1,069,000	
Develop Intersection at Romneya and Coronet	914,744	914,744	-		914,744		914,744	
Holding Account	3,600,000	3,600,000	-		3,600,000		3,600,000	
<b>Subtotal- Anaheim Campus</b>	<b>20,607,800</b>	<b>20,607,800</b>	<b>-</b>	<b>8,832,917</b>	<b>29,440,717</b>	<b>6,809,839</b>	<b>22,630,878</b>	

**General Notes:**



**DISTRICT PROJECT ALLOCATION BUDGETS REPORT**  
**3/31/2020**

Project	Measure J Bond		Measure J Bond		TOTAL BUDGET ACTUAL EXPENSE	Balance
	2/29/2020	3/31/2020	Revised Budget	3/31/2020		
	Revised Budget	Variance	Revised Budget	Other Funding		
Program Management Cost	20,000,000	-	20,000,000		20,000,000	16,082,900
Bond Issuance Costs	3,544,600	-	3,544,600		3,544,600	2,242,840
Other	400,000	400,000	800,000		800,000	539,148
<b>Subtotal - District</b>	<b>23,944,600</b>	<b>400,000</b>	<b>24,344,600</b>	<b>-</b>	<b>24,344,600</b>	<b>18,864,888</b>
<b>TOTAL: Measure J Bond and Other Funding</b>	<b>581,600,000</b>	<b>309,123</b>	<b>582,000,000</b>	<b>106,629,100</b>	<b>688,629,100</b>	<b>625,221,778</b>

NOTES:

Program Manager Fees are based on 3% of Total Project Cost, rounded up to the \$20 Million

Bond Issuance Costs are based on five Issuances over 15 years

# AERIAL VIEW — CYPRESS CAMPUS

## CAMPUS PROJECTS

Veterans' Memorial Bridge,  
Plaza, & Tribute Garden  
[Construction]



New Science, Engineering  
and Mathematics Building  
[Construction]



Fine Arts Capital Improvements  
[Pre-Planning]

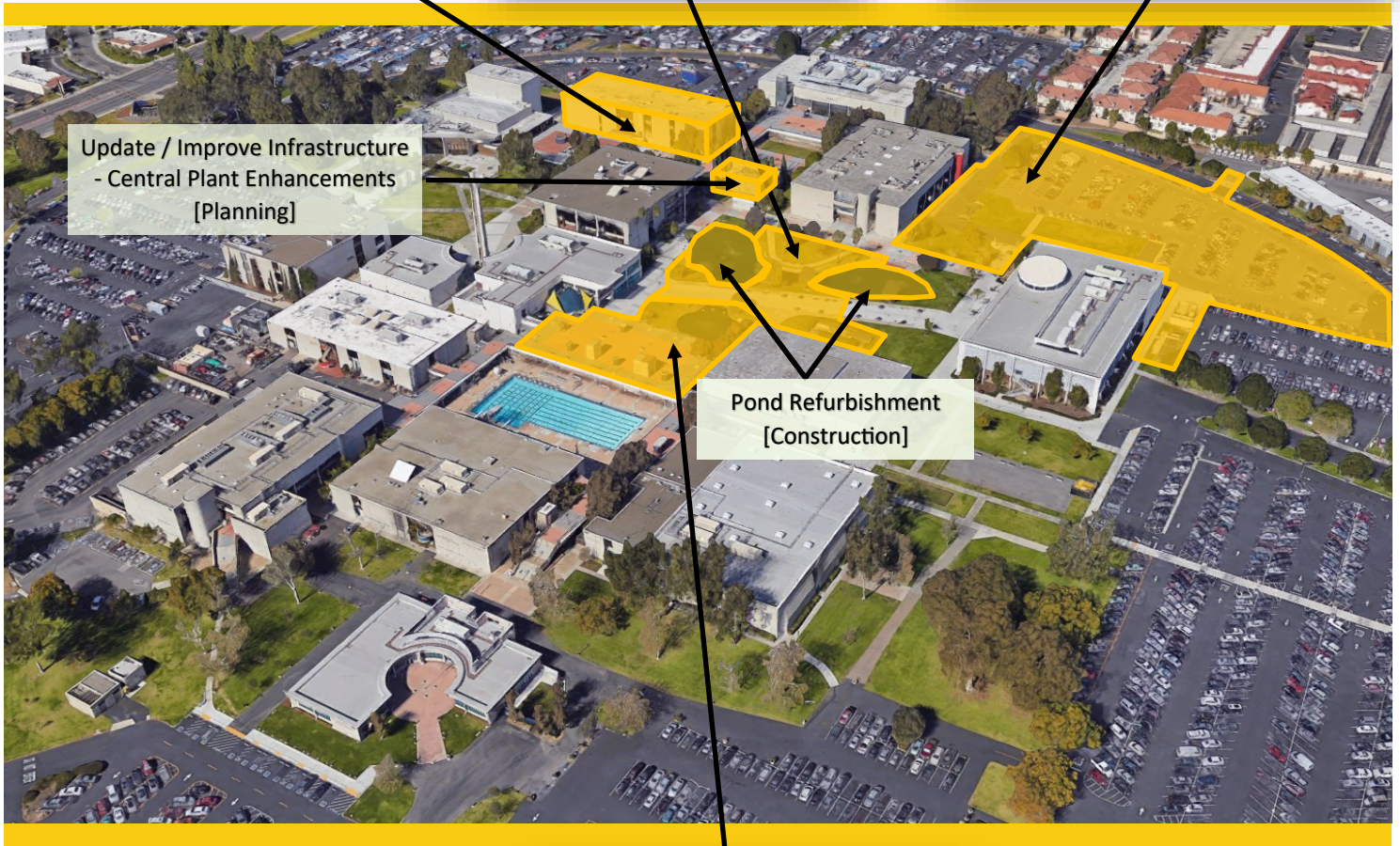

- ▶ IT Network Refresh (Throughout Campus) [Implementation]
- ▶ Mass Communications & Security Systems Upgrade - Security Cameras (Throughout Campus) [Planning]



New Veterans' Resource Center &  
Student Activities Center Expansion  
[Construction]





**North Orange County Community College District  
Measure J And Other Funding  
Finance Report  
March 31, 2020**



NORTH ORANGE COUNTY  
COMMUNITY COLLEGE DISTRICT

**Cypress**

Description	Bond	Revenue State	Local	Total Budget (all sources)	Budgeted Expenses			Expenses to Date 03/31/2020	Forecast Total Cost	Variance Budget - Forecast	Start Date	End Date	Status Cost Sch
					Hard Cost	Soft Cost	Contingency						
New Science, Engineering, and Mathematics Building	94,322,272	-	3,000,000	97,322,272	77,412,849	15,416,448	4,492,975	30,968,476	-	6/29/16	10/4/21	N/A	
New Veterans' Resource Center & Student Activities Center Expansion	13,500,000	-	-	13,500,000	9,282,801	2,110,924	2,106,475	6,094,155	-	12/9/16	2/5/21	N/A	
Veterans' Memorial Bridge, Plaza, and Tribute Garden	100,800	-	1,500,000	1,600,800	865,218	180,668	554,914	451,685	-	12/9/16	12/7/20	N/A	
Pond Refurbishment	-	-	682,017	682,017	549,624	98,014	34,379	468,262	-	12/9/16	12/7/20	N/A	
Fine Arts Capital Improvement	16,764,338	18,133,000	-	34,897,338	19,891,483	10,818,175	4,187,681	-	-	1/6/20	10/3/24	N/A	
Update/Improve Infrastructure	14,448,061	-	-	14,448,061	8,235,395	4,478,899	1,733,767	-	-	6/1/16	12/31/30	N/A	
Update/Improve Infrastructure (New SEM)	2,801,641	-	-	2,801,641	2,801,641	-	-	2,269,178	-	3/27/17	7/29/21	N/A	
Update/Improve Infrastructure (IT)	6,000,000	-	-	6,000,000	3,420,000	1,860,000	720,000	192,988	-	7/24/19	6/1/21	N/A	
Update/Improve Infrastructure (VRC/SAC)	1,055,923	-	-	1,055,923	1,055,923	-	-	910,224	-	3/27/17	9/28/20	N/A	
Update/Improve Infrastructure (Central Plant Enhancements)	32,207	-	-	32,207	-	32,207	-	-	-	TBD	TBD	N/A	
Planning (Non Project Specific)	520,000	-	-	520,000	-	520,000	-	150,807	-	6/1/16	12/29/23	N/A	
Library-Learning Resource Center Expansion	15,000,000	-	-	15,000,000	7,734,632	4,970,400	2,294,968	38,665	-	5/31/24	4/30/29	N/A	
Swing Space Projects	3,236,521	-	-	3,236,521	1,844,817	1,003,322	388,383	2,202,518	-	6/1/16	9/30/19	N/A	
Mass Communications & Security Systems Upgrade	4,026,887	-	-	4,026,887	2,295,326	1,248,335	483,226	-	-	3/27/17	1/24/30	N/A	
Mass Communications & Security Systems Upgrade (New SEM)	305,333	-	-	305,333	305,333	-	-	13,882	-	3/27/17	7/29/21	N/A	
Mass Communications & Security Systems Upgrade (Safety Film)	145,774	-	-	145,774	145,774	-	-	145,772	-	4/24/18	9/19/18	N/A	
Mass Communications & Security Systems Upgrade (Door Replacement)	50,898	-	-	50,898	50,898	-	-	50,898	-	4/24/18	1/2/19	N/A	
Mass Communications & Security Systems Upgrade (VRC/SAC)	60,938	-	-	60,938	60,938	-	-	12,771	-	3/27/17	9/28/20	N/A	
Mass Communications & Security Systems Upgrade (Cameras)	58,670	-	-	58,670	-	58,670	-	-	-	TBD	TBD	N/A	
Pool Restoration and Upgrade	4,876,000	-	-	4,876,000	2,779,320	1,511,560	585,120	-	-	4/1/26	3/30/29	N/A	
Gym IV Gym II Restoration and Restrooms	4,837,500	-	-	4,837,500	2,757,375	1,499,625	580,500	-	-	1/1/27	12/31/29	N/A	
Gateway Phase I	5,810,000	-	-	5,810,000	3,311,700	1,801,100	697,200	-	-	10/1/27	7/31/30	N/A	
Under Piazza & Stairwell Restoration	1,963,800	-	-	1,963,800	1,119,366	608,778	235,656	-	-	9/1/28	2/28/31	N/A	
Tech I/Tech III Capital Improvements	27,645,342	22,500,000	-	50,145,342	28,582,845	15,545,056	6,017,441	-	-	5/1/30	8/31/35	N/A	
Athletic Field Realignment/Entry Revisions/Parking Lot Improvements	8,358,295	-	-	8,358,295	4,764,228	2,591,071	1,002,995	-	-	5/1/31	3/29/35	N/A	
Parking Structure	-	-	-	-	-	-	-	-	-	-	-	N/A	
<b>Cypress Campus Total:</b>	<b>225,921,200</b>	<b>40,633,000</b>	<b>5,182,017</b>	<b>271,736,217</b>	<b>179,267,285</b>	<b>66,353,252</b>	<b>26,115,680</b>	<b>43,970,281</b>	<b>-</b>	<b>-</b>	<b>-</b>	<b>N/A</b>	

**General Notes:**

- DWG Corporation (Bronze Impellers) - \$15,707.21 PO to be revised from SEM Fund 49553 to Update/Improve Utilities Fund 49559.
- P2S Engineering (Engineering services - Chilled Water Booster Pumps) - \$16,500. - PO to be revised from SEM Fund 49553 to Update/Improve Utilities Fund 49559. Transfer of expenditures in the amount of \$13,406. is required from 49553 to Fund 49559.
- Guidepost Solutions, LLC (Security Assessment) - \$58,670.

# PROJECT STATUS REPORT – CYPRESS CAMPUS

## NEW SCIENCE, ENGINEERING, AND MATHEMATICS BUILDING

### CONSTRUCTION

<b>Address</b>	<b>9200 Valley View St. Cypress, CA 90630</b>
<b>Project Manager</b>	<b>Michael Zari Cypress College</b>
<b>Architect</b>	<b>LPA, Inc.</b>
<b>Construction Manager at Risk</b>	<b>Sundt Construction, Inc.</b>
<b>Project Gross Square Footage</b>	<b>106,023 GSF</b>
<b>DSA Application A#</b>	<b>04-117024</b>



### Project Overview

High priority project to increase the efficiency of the square footage and accommodation of services for Science, Engineering, and Mathematics programs with 21 lecture and 23 lab classrooms, an Immersive Digital Classroom (IDC), and an incinerator for the Mortuary Science Program.

### Budget & Construction Costs

- Total Project Budget (Est.) ..... \$100,429,246
  - New SEM Building (Est.) ..... \$94,322,272
  - New SEM FF&E ..... \$3,000,000
  - Infrastructure (Est.) ..... \$2,801,641
  - Mass Communication (Est.) ..... \$305,333
- Funding Sources ..... Measure J & Campus
  - Measure J (Est.) ..... \$97,429,246
  - Campus Funds (Est. FF&E) ..... \$3,000,000
- Construction Cost ..... \$80,532,546

### Schedule

- Design Start ..... Jun. 29, 2016
- Construction Start ..... Feb. 6, 2019
- Targeted Substantial Completion ..... Apr. 2021
- Targeted Construction Completion ..... Jun. 2021
- Targeted Academic Occupancy ..... Aug. 2021

Allowances and Contingencies Status					
	In Contract	Approved	%	Balance	%
CM Allowance <sup>1</sup>	\$1,031,360	\$64,133	6.2	\$1,095,493	106.2
District Allowance	\$1,858,120	\$889,600	47.9	\$968,520	52.1
CM Contingency	\$1,437,988	\$148,812	10.3	\$1,289,176	89.7

1. Balances exceed initial allocation as a result of a variety of credits.



# PROJECT STATUS REPORT – CYPRESS CAMPUS

## NEW SCIENCE, ENGINEERING, AND MATHEMATICS BUILDING

### CONSTRUCTION

#### Potential Changes to Project - April 6th, 2020

A total of 110 potential change orders (PCOs) are under consideration as of April 6th, 2020. Out of the currently active PCOs, 1 has a potential cost or time impact to date. Listed costs to date are preliminary and will be attributed to established allowances and contingencies

PCO Number	Description of PCO	PCO Reason	Preliminary Funding Source	Estimated Amount
S0267	Revisions to Electrical Single Line Diagrams	Document Coordination	District Allowance	\$18,676

A final cost will be assembled upon completion of the work. No additional costs to the contracted amount are anticipated to date.



# PROJECT STATUS REPORT — CYPRESS CAMPUS

## NEW VETERANS’ RESOURCE CENTER & STUDENT ACTIVITIES CENTER EXPANSION CONSTRUCTION

<b>Address</b>	<b>9200 Valley View St. Cypress, CA 90630</b>
<b>Project Manager</b>	<b>Michael Zari Cypress College</b>
<b>Architect</b>	<b>LPA, Inc.</b>
<b>Construction Manager at Risk</b>	<b>Sundt Construction, Inc.</b>
<b>Project Gross Square Footage</b>	<b>12,119 GSF</b>
<b>DSA Application A#</b>	<b>04-117023</b>



### Project Overview

High priority project to increase the square footage and provide new accommodation of services for the Veterans’ Resource Center (VRC)/Student Activities Center (SAC) Expansion.

### Budget & Construction Costs

- Total Project Budget (Est.) ..... \$14,616,861
- VRC/SAC Building (Est.) ..... \$13,500,000
- Infrastructure (Est.) ..... \$1,055,923
- Mass Communication (Est.)..... \$60,938
- Funding Sources..... Measure J
- Measure J (Est.) ..... \$14,616,861
- Construction Cost..... \$9,834,968

### Schedule

- Design Start ..... Dec. 9, 2016
- Construction Start ..... Feb. 6, 2019
- Targeted Substantial Completion ..... Aug. 2020
- Targeted Construction Completion..... Oct. 2020
- Targeted Academic Occupancy..... Oct. 2020

Allowances and Contingencies Status					
	In Contract	Approved	%	Balance	%
CM Allowance	\$257,840	\$4,112	1.6	\$253,728	98.4
District Allowance	\$214,530	\$184,928	86.2	\$29,602	13.8
CM Contingency	\$168,797	\$34,042	20.2	\$134,755	79.8





# PROJECT STATUS REPORT – CYPRESS CAMPUS

## NEW VETERANS' RESOURCE CENTER & STUDENT ACTIVITIES CENTER EXPANSION CONSTRUCTION

### Potential Changes to Project - April 6th, 2020

A total of 107 potential change orders (PCOs) are under consideration as of April 6th, 2020. Out of the currently active PCOs, 5 have a potential cost or time impact to date. Listed costs to date are preliminary and will be attributed to established allowances and contingency:

PCO Number	Description of PCO	PCO Reason	Preliminary Funding Source	Estimated Amount
V0007R1	DSA Changes to Addenda	Document Coordination	Change Order Request	\$919
V0027R1	Pond Shoreline Finish - Mockup	Document Coordination	Change Order Request	\$6,627
V0043R1	Additional 6" Bedding at Fountain Pipe Trench at Bridge	Document Coordination	Change Order Request	\$2,216
V0066R1	Gas Valve Repair at Building 8	Unforeseen Condition	District Allowance	(\$241)
V0070	Security System Package Details/Award	Document Coordination	Change Order Request	\$34,100

A final cost will be assembled upon completion of the work. No additional costs to the contracted amount are anticipated to date.



# PROJECT STATUS REPORT — CYPRESS CAMPUS

## VETERANS’ MEMORIAL BRIDGE, PLAZA, & TRIBUTE GARDEN CONSTRUCTION

<b>Address</b>	<b>9200 Valley View St. Cypress, CA 90630</b>
<b>Project Manager</b>	<b>Michael Zari Cypress College</b>
<b>Architect</b>	<b>LPA, Inc.</b>
<b>Construction Manager at Risk</b>	<b>Sundt Construction, Inc.</b>
<b>Project Square Footage</b>	<b>63,192 GSF</b>
<b>DSA Application A#</b>	<b>04-117023</b>



### Project Overview

Construction of a Veterans’ Memorial Bridge (VMB), Tribute Garden, and site improvements to adjacent areas, including the Veterans’ Resource Center Plaza.

### Budget & Construction Costs

- Funding Sources ..... Measure J & Local
- Total Project Budget (Est.) ..... \$1,600,800
  - Measure J (Est.) ..... \$100,800
  - Local (Est.) ..... \$1,500,000
- Construction Cost ..... \$1,138,359

### Schedule

- Design Start ..... Dec. 9, 2016
- Construction Start ..... Feb. 6, 2019
- Targeted Substantial Completion ..... Dec. 2019
- Targeted Construction Completion ..... Apr. 2020
- Targeted Occupancy ..... Apr. 2020

Allowances and Contingencies Status					
	In Contract	Approved	%	Balance	%
CM Contingency	\$19,538	\$9,762	50.0	\$9,776	50.0



# PROJECT STATUS REPORT – CYPRESS CAMPUS

## POND REFURBISHMENT CONSTRUCTION

<b>Address</b>	<b>9200 Valley View St. Cypress, CA 90630</b>
<b>Project Manager</b>	<b>Michael Zari Cypress College</b>
<b>Architect</b>	<b>LPA, Inc.</b>
<b>Construction Manager at Risk</b>	<b>Sundt Construction, Inc.</b>
<b>Project Square Footage</b>	<b>16,357 GSF</b>
<b>DSA Application A#</b>	<b>04-117023</b>



### Project Overview

Repairs and refurbishment of existing ponds. Replacement of pond lining and rearrangement of water features.

### Budget & Construction Costs

- Funding Sources ..... Local
- Total Project Budget (Est.) ..... \$682,017
  - Local (Est.)..... \$682,017
- Construction Cost..... \$546,468

### Schedule

- Design Start ..... Dec. 9, 2016
- Construction Start ..... Feb. 6, 2019
- Targeted Substantial Completion ..... Dec. 2019
- Targeted Construction Completion..... Apr. 2020
- Targeted Occupancy ..... Apr. 2020

Allowances and Contingencies Status					
	In Contract	Approved	%	Balance	%
CM Contingency	\$9,379	\$7,463	79.6	\$1,916	20.4

# PROJECT STATUS REPORT – CYPRESS CAMPUS

## FINE ARTS CAPITAL IMPROVEMENTS

### PRE-PLANNING

<b>Address</b>	<b>9200 Valley View St. Cypress, CA 90630</b>
<b>Project Manager</b>	<b>Michael Zari Cypress College</b>
<b>Architect</b>	<b>TBD</b>
<b>Project Delivery Method</b>	<b>Design-Bid-Build</b>

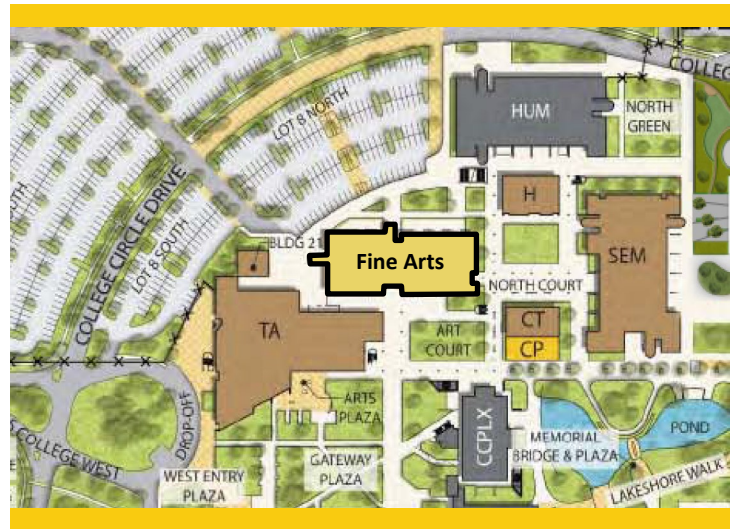

### Project Overview

The project involves the renovation of the existing 36,804 ASF in the Fine Arts Building #2. Currently, related instructional programs are dispersed throughout the campus. Renovations will encompass functional and adequate recording arts, rehearsal and performance spaces for music instruction, spaces for student study near departmental faculty and other resources, and the reuse of existing vacant spaces currently not configured for instruction. Noise intrusion between spaces will be mitigated to minimize disruptions to instruction and music practice, and new instructional technology will be installed to support current instructional methodologies and pedagogies. The scope also replaces the existing mechanical, electrical, and plumbing systems and allocates sufficient square footages for code compliant bathrooms.

- Preliminary Total Project Budget..... \$34,897,338
- Funding Source ..... Measure J & State Capital Outlay
  - Measure J ..... \$16,764,338
  - State Capital Outlay Funds ..... \$18,133,000 (As Approved in FPP)
- Project Gross Square Footage..... 66,765 GSF
- Estimated Construction Start..... Fall 2022
- Targeted Completion ..... Winter 2023/24



# PROJECT STATUS REPORT – CYPRESS CAMPUS

## SWING SPACE PROJECTS

### CLOSE-OUT

<b>Address</b>	<b>9200 Valley View St. Cypress, CA 90630</b>
<b>Project Manager</b>	<b>Michael Zari / Phil Fleming Cypress College</b>
<b>Architect</b>	<b>(See Updates on Projects)</b>
<b>Project Delivery Method</b>	<b>(See Updates on Projects)</b>



### Project Overview

Currently, there are three different completed Swing Space Projects. Roof repairs were performed using Scheduled Maintenance Funds at the existing SEM Building, which will be occupied as a swing space upon the completion of the New SEM building. Available space within Gym II is accommodating the Student Activities Center (SAC) activities during construction of the New VRC/SAC. Parking Lot 5 South was reconfigured to increase parking capacity by 385 spaces to compensate for the loss of 200 stalls resulting from the construction site for the New SEM Building. For additional information on completed projects refer to page 48.

- Total Project Budget ..... \$3,236,521
- Funding Source ..... Measure J
  - Parking Lot #5 ..... \$1,957,594 - Complete
  - VRC / SAC Swing Space to Gym II..... \$153,402 - Complete
  - Other Swing Space Projects ..... \$102,922 - Complete
  - Unallocated Balance ..... \$1,022,108 (Estimated)



# PROJECT STATUS REPORT — CYPRESS CAMPUS

## UPDATE/IMPROVE INFRASTRUCTURE

### VARIOUS STAGES

<b>Address</b>	<b>9200 Valley View St. Cypress, CA 90630</b>	<b>Total Project Budget</b>	<b>\$24,337,832 (Measure J)</b>
		<b>Total Budget Allocated</b>	<b>\$9,889,771 (Measure J)</b>
<b>Number of Projects</b>	<b>4</b>	<b>Funding Source</b>	<b>Measure J &amp; Capital Outlay</b>

### General Overview

Projects to address infrastructure improvements or upgrades throughout the Campus. Funds are allocated to projects as needs are identified. For infrastructure projects related to the New SEM and VRC/SAC, please refer to pages 10 and 12 of this report.

### IT Network Refresh Project Overview

#### IMPLEMENTATION

Assessment of Campus data network infrastructure to identify necessary upgrades and changes that will enable supporting future campus needs; specifically addressing wired, wireless, voice, and video networks. Design of a new network will account for the District’s needs specific to logical infrastructure for the next 10 years. Physical infrastructure will also account for the District’s needs for the next 20 years. The scope includes replacing network core switches, providing a more responsive support structure, preparing for cloud computing, and adaptation of voice over IP systems across the District.

- Project Budget ..... \$9,715,286
  - Current Implementation (Measure J) ..... \$1,991,431
  - Current Implementation (Capital Outlay)..... \$3,715,286
  - Upcoming Phases (Measure J) ..... \$4,008,569
- Funding Source ..... Measure J & Capital Outlay Funds
- Project Delivery Method ..... California Multiple Award Schedule (CMAS)
- Design Implementation..... VectorUSA
- Architect..... Shandam Consulting
- Project Management ..... District IS / PlanNet Consulting
- Design Implementation Start..... November 2019
- Targeted Completion ..... April 2021



## UPDATE/IMPROVE INFRASTRUCTURE

### VARIOUS STAGES

#### Central Plant Enhancements

##### PLANNING

Field investigation to determine the efficiency of the current chilled water system. Replacement of the impellers to increase size in the current chilled water pumps to provide additional capacity for the New SEM Building

- Project Budget ..... \$32,207
- Funding Source ..... Measure J
- Project Delivery Method ..... Competitive Bidding
- Architect/Engineer of Record ..... P2S Engineering, Inc.
- Estimated Construction Start ..... May 2020
- Targeted Completion ..... July 2020



# PROJECT STATUS REPORT — CYPRESS CAMPUS

## MASS COMMUNICATION & SECURITY SYSTEMS UPGRADE

### VARIOUS STAGES

<b>Address</b>	<b>9200 Valley View St. Cypress, CA 90630</b>	<b>Total Project Budget</b>	<b>\$4,648,500</b>
		<b>Total Budget Allocated</b>	<b>\$621,613</b>
<b>Number of Projects</b>	<b>5</b>	<b>Funding Source</b>	<b>Measure J</b>

### General Overview

Projects to address fire alarm, mass communication, security, access control, and lockdown systems throughout the Campus. Funds are allocated to projects as needs are identified. Two projects have been completed to date related to door replacements and safety film installation. Please refer to page 50 for additional details on completed projects. For mass communication & security systems projects related to the New SEM and VRC/SAC, please refer to pages 10 and 12 of this report.

### Security Cameras

#### PLANNING

Assessment of the campus security system and development of security system standards.

- Project Budget ..... \$58,670
- Funding Source ..... Measure J
- Project Delivery Method ..... To Be Determined
- Architect/Engineer of Record ..... To Be Determined
- Estimated Construction Start ..... To Be Determined
- Targeted Completion ..... To Be Determined





# PROJECT STATUS REPORT – CYPRESS CAMPUS

## UPDATES ON CAMPUS PROJECTS - CYPRESS COLLEGE

### New Science, Engineering, and Mathematics Building

- Fireproofing protection is being installed along the first floor of the south wing of the structure. Application of the spray-applied fire-resistive material (SFRM) will continue throughout the building as mechanical, electrical, and plumbing inserts are fastened to the steel structure. Concrete has been poured on the second floor of the structure's north and south wings. Rebar installation is nearing its end on the third floor. Structural Steel framing is being installed for roof support and equipment support at the IDC. Foundations are being excavated at the site yard on the north end of the site.
- Changes to the approved construction documents shall be made by means of Construction Change Documents or CCD. Changes which affect the Structural, Access or Fire & Life Safety portions of the project must be submitted to DSA for review and approval. The following is a brief tally of the CCDs issued to date for this project:

Status	Number of CCDs Class A	Number of CCDs Class B
Completed and Issued	41	24
In Review at DSA	3	0
Distributed for Review	0	0
In Progress / Under Development	3	4

- The Campus has set aside \$3,000,000 in funds for the building's furniture, fixtures, and equipment (FF&E). Funds from additional sources might be allocated to address shortfalls in FF&E needs. Weekly FF&E review conference calls started in mid-July in an effort to track progress on the validation of the furniture matrix.
- As of late March 2020, a total of 13 weather days have been used as a result of adverse conditions on the field. A balance of 17 weather days remains for the duration of the project.
- Prime Contract Change Order (PCCO) #07 is being evaluated by the Campus Project Team.
- There are 110 open Potential Change Orders (PCOs) for this project. For more information see page 11.
- Construction work proceeds at the site during the current Stay At Home directive from the State's Governor. Sundt is following recommendations from the CDC on social distancing and hygiene practices for all its employees and subcontractors.

### New Veterans' Resource Center & Students Activities Center Expansion

- Acoustical ceiling grid, ceiling light fixtures, and sprinkler and fire alarm components are being installed at the VRC. Activities will soon start at the SAC.
- Interior work is proceeding with the installation of exit signage and other fire alarm devices as well as parts of the low-voltage components embedded in the ceiling tiles. Bathroom finishes are also progressing with tiling to take place in late April.
- Changes to the approved construction documents shall be made by means of Construction Change



# PROJECT STATUS REPORT – CYPRESS CAMPUS

## UPDATES ON CAMPUS PROJECTS - CYPRESS COLLEGE (Continued)

Documents or CCD. Changes which affect the Structural, Access or Fire & Life Safety portions of the project must be submitted to DSA for review and approval. The following is a brief tally of the CCDs issued to date for this project:

Status	Number of CCDs Class A	Number of CCDs Class B
Completed and Issued	14	20
In Review at DSA	1	0
Distributed for Review	0	0
In Progress / Under Development	2	3

- As of late March 2020, a total of 13 weather days have been used as a result of adverse conditions on the field. A balance of 17 weather days remains for the duration of the project
- Prime Contract Change Order (PCCO) #07 is being evaluated by the Campus Project Team.
- There are 107 open Potential Change Orders (PCOs) for this project. For more information see page 13.
- Construction work proceeds at the site during the current Stay At Home directive from the State's Governor. Sundt is following recommendations from the CDC on social distancing and hygiene practices for all its employees and subcontractors.

### **Veterans' Memorial Bridge, Plaza, and Tribute Garden**

- Sprinklers for landscape irrigation have been installed and will be tested for coverage of areas. Soil amends will be placed in early April. Formwork is being installed for pathways leading to the bridge and Tribute Garden area. Pouring of concrete will take place in the last weeks of April
- Scope of work encompassing pond refurbishment beyond the necessary for completion of the new VRC will be completed using one-time Campus funding.
- Prime Contract Change Order (PCCO) #07 is being evaluated by the Campus Project Team.
- Construction work proceeds at the site during the current Stay At Home directive from the State's Governor. Sundt is following recommendations from the CDC on social distancing and hygiene practices for all its employees and subcontractors.

### **Pond Refurbishment**

- Curing of concrete for the pond edges has been completed. Lighting, water jet fixtures, and water pump equipment are installed in preparation for testing.
- Prime Contract Change Order PCCO #07 is being evaluated by the Campus Project Team.
- Construction work proceeds at the site during the current Stay At Home directive from the State's Governor. Sundt is following recommendations from the CDC on social distancing and hygiene practices for all its employees and subcontractors.



# PROJECT STATUS REPORT – CYPRESS CAMPUS

## UPDATES ON CAMPUS PROJECTS - CYPRESS COLLEGE (Continued)

### Fine Arts Capital Improvements

- The Fine Arts Renovation FPP is being updated regarding the Maintenance and Operation budget for the first year of occupancy. Upon revision of data with escalation the revised FPP will be resubmitted to CCCO.

### Swing Space Projects

- No updates for this reporting period.

### Update / Improve Infrastructure

#### IT Network Refresh Project

- A Change Order will be released for review and approval of the District in late April. It encompasses a new parts list that will be provided to the District with potential zero cost impacts but is inclusive of a schedule impact to the project completion date.
- Implementation work proceeds at the site during the current Stay At Home directive from the State's Governor. VectorUSA is following recommendations from the CDC on social distancing and hygiene practices for all its employees.

#### Central Plant Enhancements

- P2S Engineering has provided preliminary results to the assessment of hydronic line pressure and layout. New pump impellers will enhance capacity for the existing pumps and will be required to be installed to meet demand for heating and cooling during peak demand periods. Preparations for this project are underway.
- The following purchase orders over \$10,000 have been issued during the current reporting period:

Vendor	Purchase Order No.	Purchase Order Amount	Scope of Work
DMG Corporation	P0138837	\$15,707	Impellers and Other Parts for CHW Flow Enhancements

### Mass Communication & Security Systems Upgrade

#### Security Cameras

- The following purchase orders over \$10,000 have been issued during the current reporting period:

Vendor	Purchase Order No.	Purchase Order Amount	Scope of Work
Guidepost Solutions	P0138741	\$58,670	Assessment and Standards for Security Cameras



# AERIAL VIEW — FULLERTON CAMPUS

## CAMPUS PROJECTS

- IT Network Refresh (Throughout Campus)  
[Implementation]

Update / Improve  
Infrastructure - Sewer Line  
Replacement to Buildings  
300 & 500  
[Bidding]

New Maintenance & Operations  
Building  
[Pre-Planning]

New Parking Structure  
[Pre-Planning]



New Instructional Building  
[Construction]



Renovate Buildings 300 & 500  
[Pre-Bidding]



Central Plant  
Replacement and  
Expansion  
[Construction]





**North Orange County Community College District  
Measure J And Other Funding  
Finance Report  
March 31, 2020**

**Fullerton**

Description	Bond	Revenue State	Local	Total Budget (all sources)	Budgeted Expenses			Expenses to Date 03/31/2020	Forecasted Total Cost	Variance Budget - Forecast	Start Date	End Date	Status
					Hard Cost	Soft Cost	Contingency						
New Instructional Building	53,588,031	-	-	53,588,031	41,322,198	10,338,468	1,927,364	4,142,394	-	6/29/17	7/13/21	N/A	
Renovate Buildings 300 & 500	20,482,000	15,348,000	-	35,830,000	27,334,596	5,337,235	3,210,169	1,663,542	-	6/19/17	12/30/22	N/A	
Central Plant Replacement & Expansion	10,600,000	-	-	10,600,000	8,110,722	1,538,895	950,382	1,028,438	-	6/29/17	7/7/21	N/A	
New Thermal Energy Storage (TES)	10,139,524	-	-	10,139,524	5,659,300	768,918	3,711,306	-	-	7/8/21	8/11/25	N/A	
Update/Improve Infrastructure (IT)	23,007,362	-	-	23,007,362	13,114,196	7,132,282	2,760,883	-	-	5/1/18	5/30/31	N/A	
Update/Improve Infrastructure (IT)	8,000,000	-	-	8,000,000	4,560,000	2,480,000	960,000	13,706	-	7/24/19	9/21/21	N/A	
Update/Improve Infrastructure (Bldg 300-500 Sewer Line)	363,292	-	91,013	454,305	258,954	140,835	54,517	67,713	-	5/1/18	8/17/20	N/A	
Planning (Non Project Specific)	595,000	-	-	595,000	-	595,000	-	231,697	-	6/6/16	12/29/23	N/A	
New Parking Structure	33,205,037	-	-	33,205,037	27,468,604	4,355,498	1,380,936	-	-	8/1/20	4/30/24	N/A	
New M & O Building	6,758,944	-	8,000,000	14,758,944	11,505,955	2,206,444	1,046,546	-	-	8/1/20	4/30/24	N/A	
New Horticulture/Lab School/STEM Lab	34,648,145	-	-	34,648,145	26,633,817	5,591,801	2,422,528	-	-	9/1/21	9/29/25	N/A	
New Performing Arts Complex—Phase 1	16,133,000	16,133,000	-	32,266,000	18,391,620	10,002,460	3,871,920	-	-	6/14/21	8/4/25	N/A	
New Performing Arts Complex—Phase 2	12,409,153	12,409,153	-	24,818,306	14,146,434	7,693,675	2,978,197	-	-	8/5/25	11/30/28	N/A	
New Welcome Center & Lot C West	37,353,872	-	-	37,353,872	21,291,707	11,579,700	4,482,465	-	-	1/1/25	6/1/29	N/A	
Demolish Buildings 1100, 1300 and 2300	2,182,000	-	-	2,182,000	1,243,740	676,420	261,840	-	-	6/1/27	5/31/29	N/A	
Demolish Building 2000	1,108,000	-	-	1,108,000	631,560	343,480	132,960	-	-	6/1/27	9/29/28	N/A	
Renovate Building 800	3,117,641	-	-	3,117,641	1,777,055	966,469	374,117	-	-	6/1/27	7/31/30	N/A	
Renovate Building 840 Campus Services	7,878,400	-	-	7,878,400	4,490,688	2,442,304	945,408	-	-	12/1/28	1/30/32	N/A	
Renovate Health Center	1,328,800	-	-	1,328,800	757,416	411,928	159,456	-	-	12/1/28	12/31/30	N/A	
Renovate Faculty Lounge & Offices	6,212,250	-	-	6,212,250	3,540,983	1,925,798	745,470	-	-	5/1/30	2/28/34	N/A	
Renovate Wellness Center	2,534,400	-	-	2,534,400	1,444,608	785,664	304,128	-	-	5/1/30	10/29/32	N/A	
Landscape & Hardscape Improvements	3,840,000	-	-	3,840,000	2,188,800	1,190,400	460,800	-	-	5/1/30	1/31/33	N/A	
Renovate Building 3100	2,639,340	-	-	2,639,340	1,504,424	818,195	316,721	-	-	9/1/31	2/28/33	N/A	
Demolish Buildings 1901-04, 1956-60, 3000	1,333,000	-	-	1,333,000	759,810	413,230	159,960	-	-	9/1/31	12/31/32	N/A	
Parking Lot Improvements at Building 3000	1,999,500	-	-	1,999,500	1,139,715	619,845	239,940	-	-	9/1/31	8/31/33	N/A	
Renovate Building 2100	8,277,500	-	-	8,277,500	4,718,175	2,566,025	993,300	-	-	1/1/25	12/29/28	N/A	
Demolish Buildings 2200 & 3104	1,392,209	-	-	1,392,209	793,559	431,585	167,065	-	-	9/1/28	7/31/31	N/A	
Renovate Building 100	-	-	-	-	-	-	-	-	-	-	-	N/A	
Renovate Building 1000 Fine Arts Gallery	-	-	-	-	-	-	-	-	-	-	-	N/A	
Chapman Newell Instructional Building	-	-	-	-	-	-	-	-	-	-	-	N/A	
<b>Fullerton Campus Total:</b>	<b>311,126,400</b>	<b>43,890,153</b>	<b>8,091,013</b>	<b>363,107,566</b>	<b>244,788,636</b>	<b>83,352,553</b>	<b>35,018,377</b>	<b>7,147,490</b>	<b>-</b>	<b>-</b>	<b>-</b>	<b>N/A</b>	

General Notes:

# PROJECT STATUS REPORT – FULLERTON CAMPUS

## NEW INSTRUCTIONAL BUILDING CONSTRUCTION

<b>Address</b>	321 E. Chapman Ave. Fullerton, CA 92832
<b>Project Manager</b>	Oscar Saghieh Fullerton College
<b>Design-BUILDER</b>	BNBuilders, Inc. & Roesling Nakamura Terada Architects, Inc.
<b>Project Delivery Method</b>	Progressive Design-Build
<b>Project Gross Square Footage</b>	74,927 GSF
<b>DSA Application A#</b>	04-118108



### Project Overview

The building will help meet campus growth needs with the goal of consolidating an instructional division into a single building. The building will accommodate more than 40 classrooms and the division office services including staff offices. Scope of work for this projects includes the expansion of the Central Plant. Refer to page 27 of this report for information.

### Budget & Construction Costs

- Funding Source ..... Measure J
- Total Project Budget ..... \$53,588,031  
Measure J (Est.) ..... \$53,588,031
- Construction Cost..... \$41,231,023

### Schedule

- Design Start .....Jun. 18, 2018
- Construction Start ..... Feb. 12, 2020
- Targeted Substantial Completion .....Jun. 2021
- Targeted Occupancy. ....Aug. 2021

	Allowances and Contingencies Status				
	In Contract	Approved	%	Balance	%
Construction Contingency	\$1,082,149	\$0	0	\$1,082,149	100
Allowance	\$1,751,617	\$0	0	\$1,751,617	100



# PROJECT STATUS REPORT — FULLERTON CAMPUS

## CENTRAL PLANT REPLACEMENT & EXPANSION CONSTRUCTION

<b>Address</b>	321 E. Chapman Ave. Fullerton, CA 92832
<b>Project Manager</b>	Oscar Saghieh Fullerton College
<b>Design-Builder</b>	BNBuilders, Inc. & Roesling Nakamura Terada Architects, Inc.
<b>Project Delivery Method</b>	Progressive Design-Build
<b>Project Gross Square Footage</b>	2,028 GSF
<b>DSA Application A#</b>	04-118525

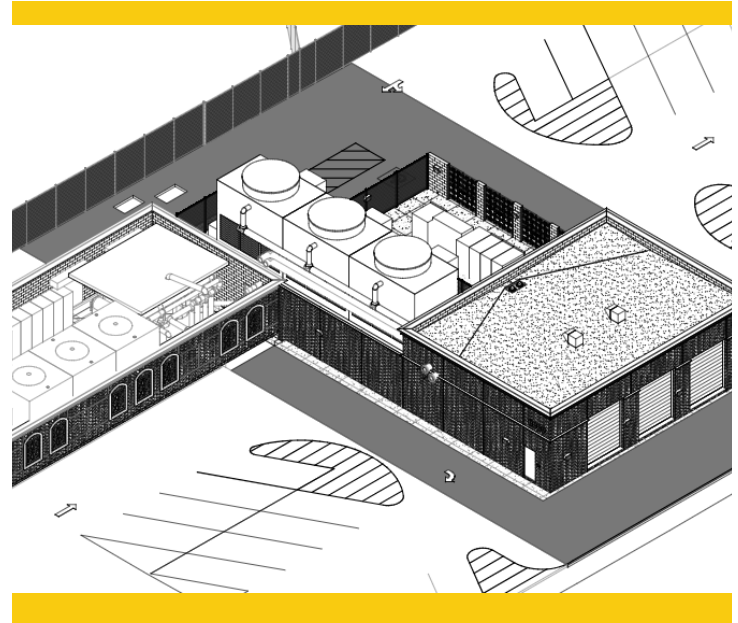

### Project Overview

Replacement and expansion of the Central Plant to accommodate planned new facilities and renovations and improve efficiency in servicing existing buildings. Project includes the replacement and expansion of the existing central plant to accommodate for three 600-ton high-efficiency water chillers and cooling towers.

### Budget & Construction Costs

- Funding Source.....Measure J
- Total Project Budget.....\$10,600,000  
Measure J (Est.).....\$10,600,000
- Construction Cost.....\$8,093,803

### Schedule

- Design Start ..... Jun. 18, 2018
- Construction Start ..... Feb. 12, 2020
- Targeted Substantial Completion..... Apr. 2021
- Targeted Occupancy..... Jun. 2021

Allowances and Contingencies Status					
	In Contract	Approved	%	Balance	%
Construction Contingency	\$195,037	\$0	0	\$195,037	100
Allowance	\$7,500	\$0	0	\$7,500	100



# PROJECT STATUS REPORT – FULLERTON CAMPUS

## RENOVATE BUILDINGS 300 & 500

### PRE-BIDDING

<b>Address</b>	<b>321 E. Chapman Ave. Fullerton, CA 92832</b>
<b>Project Manager</b>	<b>Oscar Saghieh Fullerton College</b>
<b>Architect</b>	<b>R2A Architecture</b>
<b>General Contractor</b>	<b>TBD</b>
<b>Project Delivery Method</b>	<b>Design-Bid-Build</b>
<b>DSA Application A#</b>	<b>04-118314</b>

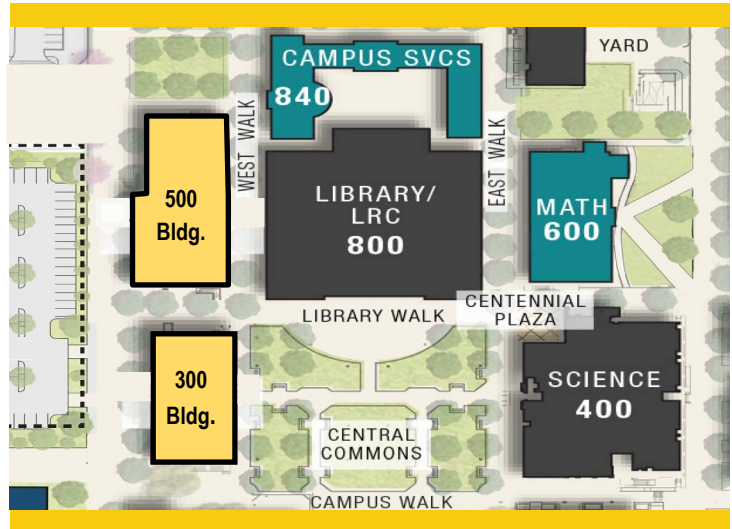

### Project Overview

Total renovation of Buildings 300 and 500, including historic consideration of Building 300. The renovated buildings will contain general classrooms, CIS laboratories, ACT laboratories, photography laboratories, Dean and faculty offices, shared laboratories, and a lecture hall.

- Total Project Budget .....\$35,830,000
- Funding Source .....Measure J & State Capital Outlay
  - Measure J .....\$20,482,000
  - State Capital Outlay Funds .....\$15,348,000
- Project Gross Square Footage.....55,451 GSF
- Estimated Construction Start.....Summer 2021
- Targeted Completion .....Winter 2022/23





# PROJECT STATUS REPORT — FULLERTON CAMPUS

## NEW PARKING STRUCTURE PRE-PLANNING

<b>Address</b>	<b>321 E. Chapman Ave. Fullerton, CA 92832</b>
<b>Project Manager</b>	<b>Oscar Saghieh Fullerton College</b>
<b>Architect</b>	<b>TBD</b>
<b>Project Delivery Method</b>	<b>TBD</b>

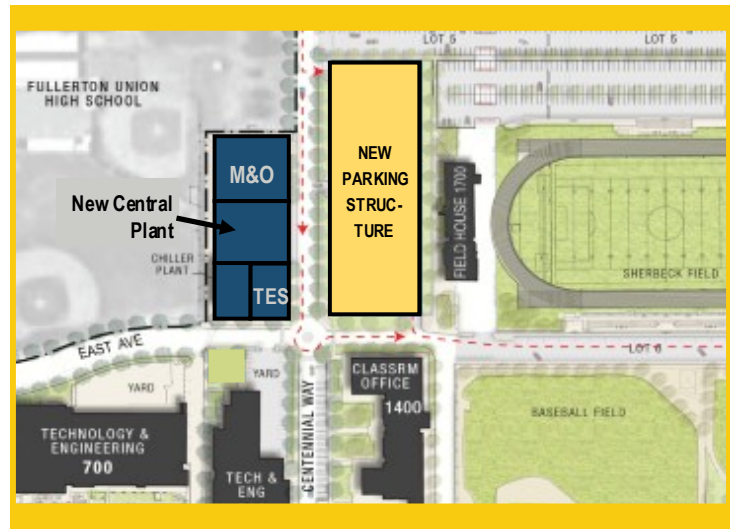

### Project Overview

New parking structure building to accommodate the need for additional parking for staff and students, with 840 spaces not exceeding 4 Levels.

- Total Project Budget .....\$33,205,037
- Funding Source .....Measure J
- Project Gross Square Footage.....260,000 GSF
- Estimated Construction Start.....Winter 2023
- Targeted Completion .....Summer 2024



# PROJECT STATUS REPORT — FULLERTON CAMPUS

## NEW MAINTENANCE & OPERATION BUILDING PRE-PLANNING

<b>Address</b>	<b>321 E. Chapman Ave. Fullerton, CA 92832</b>
<b>Project Manager</b>	<b>Oscar Saghieh Fullerton College</b>
<b>Architect</b>	<b>TBD</b>
<b>Project Delivery Method</b>	<b>TBD</b>

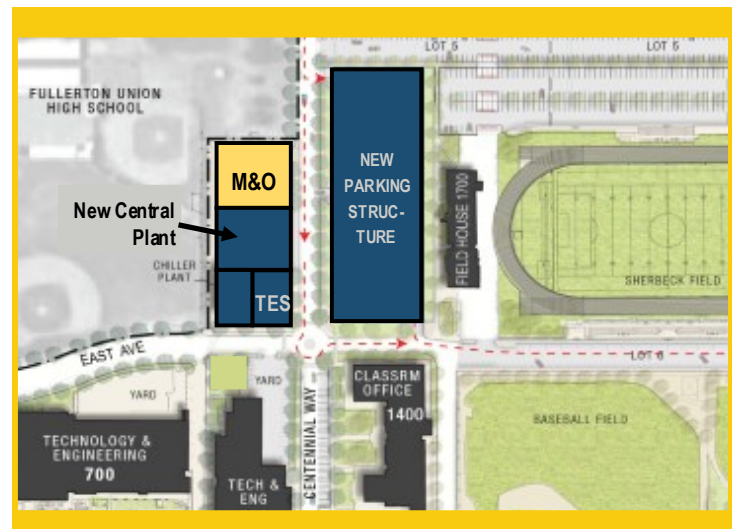

### Project Overview

The New Maintenance and Operations building will centralize all M & O services into a single building located on the main campus. The building will include trade-specific workshops for maintenance, grounds, facilities, custodial personnel while improving response time and efficiencies by locating the building on the main campus adjacent to the central plant.

- Total Project Budget .....\$14,758,944
- Funding Source .....Measure J & Local Funds
  - Measure J .....\$6,758,944
  - Local Funds.....\$8,000,000
- Project Gross Square Footage.....22,300 GSF
- Estimated Construction Start.....Winter 2023
- Targeted Completion .....Summer 2024



# PROJECT STATUS REPORT — FULLERTON CAMPUS

## UPDATE/IMPROVE INFRASTRUCTURE

### VARIOUS STAGES

<b>Address</b>	<b>321 E. Chapman Ave. Fullerton, CA 92832</b>	<b>Total Project Budget</b>	<b>\$31,370,654 (Measure J)</b>
		<b>Total Budget Allocated</b>	<b>\$8,363,292 (Measure J)</b>
<b>Number of Projects</b>	<b>2</b>	<b>Funding Source</b>	<b>Measure J &amp; Capital Outlay</b>

### General Overview

Projects to address infrastructure improvements or upgrades throughout the Campus. Funds are allocated to projects as needs are identified.

### IT Network Refresh Project Overview

#### IMPLEMENTATION

Assessment of Campus data network infrastructure to identify necessary upgrades, and changes that will enable supporting future campus needs; specifically addressing wired, wireless, voice, and video networks. Design of a new network will account for the District's needs specific to logical infrastructure for the next 10 years. Physical infrastructure will also account for the District's needs for the next 20 years. The scope includes replacing network core switches, providing a more responsive support structure, preparing for cloud computing, and adaptation of voice over IP systems across the District.

- Project Budget ..... \$12,481,383
  - Current Implementation (Measure J) ..... \$3,162,221
  - Current Implementation (Capital Outlay)..... \$4,481,383
  - Upcoming Phases (Measure J) ..... \$4,837,779
- Funding Source ..... Measure J & Capital Outlay Funds
- Project Delivery Method ..... California Multiple Award Schedule (CMAS)
- Design Implementation..... VectorUSA
- Architect..... Shandam Consulting
- Project Management ..... District IS / PlanNet Consulting
- Design Implementation Start ..... November 2019
- Targeted Completion ..... March 2021



## UPDATE/IMPROVE INFRASTRUCTURE

### VARIOUS STAGES

#### Sewer Line Replacement to Buildings 300 & 500

##### BIDDING

Design and construction for a new sewer line leading out of Building 300, and a new sewer line leading out of Building 500, as the existing lines are not functioning properly. The new sewer lines will travel from the existing buildings to the new saddle points of connection at the City of Fullerton’s sanitary sewer line, which is located on North Lemon Street.

- Project Budget ..... \$454,305
- Funding Source ..... Measure J & Scheduled Maintenance Funds
  - Measure J ..... \$363,292
  - Scheduled Maintenance Funds ..... \$91,013
- Project Delivery Method ..... Design-Bid-Build
- Architect ..... R2A Architects
- Estimated Construction Start ..... Summer 2020
- Targeted Completion ..... Summer 2020



# PROJECT STATUS REPORT — FULLERTON CAMPUS

## UPDATES ON CAMPUS PROJECTS - FULLERTON COLLEGE

### New Instructional Building

- Demolition of the existing parking lot pavement has started. Excavation is taking place along the south and northwest sides of the construction site to remove and re-route utility lines as needed. Cutting and capping all existing utilities occurred in mid-March. Rerouting of the electric bank and fire water supply line in the south side of the site began late March and will continue until mid April. Excavation has started in the south end of the construction site for the installation of a 12" storm drain line.
- Storm Water Pollution Protection Plan (SWPPP) has been installed at the majority of catch basins on site. Historic preservation plan protection measures are being prepared for installation. Devices for mitigation will be deployed in the areas near construction activities as needed in order not to impede pedestrian flow in the vicinity of Buildings 600 and 1200.
- Unforeseen conditions have been encountered in preparation for demolition at the project site. A 2" gas line and a 6" chilled water line supplying Building 1400, not found in the as-built drawings, have been identified. Rerouting of the unforeseen utilities is progressing and will be completed by early April.
- Addendum and deferred submittal for GFRC were submitted to DSA for review on March 9th, 2020. One deferred submittal for elevator guide rails is pending development and will be submitted to the State Agency at a later time.
- The following purchase orders over \$10,000 have been issued during the current reporting period:

Vendor	Purchase Order No.	Purchase Order Amount	Scope of Work
O'Connor Construction Management	P0138874	\$25,500	Schedule Review Services as Needed

- Construction work proceeds at the site during the current Stay At Home directive from the State's Governor. BNBuilders is following recommendations from the CDC on social distancing and hygiene practices for all its employees and subcontractors.

### Central Plant Replacement & Expansion

- Demolition of the current parking lot was underway in late March. Reroute of utilities will follow in early April.
- The following purchase orders over \$10,000 have been issued during the current reporting period:

Vendor	Purchase Order No.	Purchase Order Amount	Scope of Work
O'Connor Construction Management	P0138874	\$15,300	Schedule Review Services as Needed

- Construction work proceeds at the site during the current Stay At Home directive from the State's Governor. BNBuilders is following recommendations from the CDC on social distancing and hygiene practices for all its employees and subcontractors.



# PROJECT STATUS REPORT — FULLERTON CAMPUS

## UPDATES ON CAMPUS PROJECTS - FULLERTON COLLEGE (Continued)

### Renovate Buildings 300 & 500

- The final Division of the State Architect (DSA) stamped drawings have been submitted to the California Community College Chancellor's Office (CCCCO) for approval. Pre-qualification of general contractors with historical renovation experience will occur after approval and funding have been received from CCCCCO.

### New Parking Structure

- Evaluating Design-Build project delivery method.
- Project budget has been revised and increased to account for construction escalation costs at mid-point of construction. The project budget will be revised in the future closer to the onset of project design.
- Construction will not start until the renovation of 300 & 500 Buildings has been completed.
- Target Construction Start in conjunction with M&O Building - Winter 2023.

### New Maintenance & Operations Building

- Target Construction Start in conjunction with New Parking Structure - Winter 2023.
- Project budget has been revised and increased to account for construction escalation costs at mid-point of construction. The project budget will be revised in the future close to the onset of project design.

### Update / Improve Infrastructure

#### IT Network Refresh Project

- A Change Order will be released for review and approval of the District in late April. It encompasses a new parts list that will be provided to the District with potential zero cost impacts but is inclusive of a schedule impact to the project completion date.
- Implementation work proceeds at the site during the current Stay At Home directive from the State's Governor. VectorUSA is following recommendations from the CDC on social distancing and hygiene practices for all its employees.

#### Sewer Line Replacement to Buildings 300 & 500

- The District's Purchasing Department released a Notice to Bid for the project on March 5th, and March 12th, 2020. A mandatory job walk was completed on March 13th, 2020 with two companies attending the session. All bids will be due to the District on April 15th, 2020 before 2:00 P.M. at which time the submittals will be evaluated for responsiveness to the bid documents.



**Intentionally Left Blank**

# AERIAL VIEW — ANAHEIM CAMPUS

## CAMPUS PROJECTS

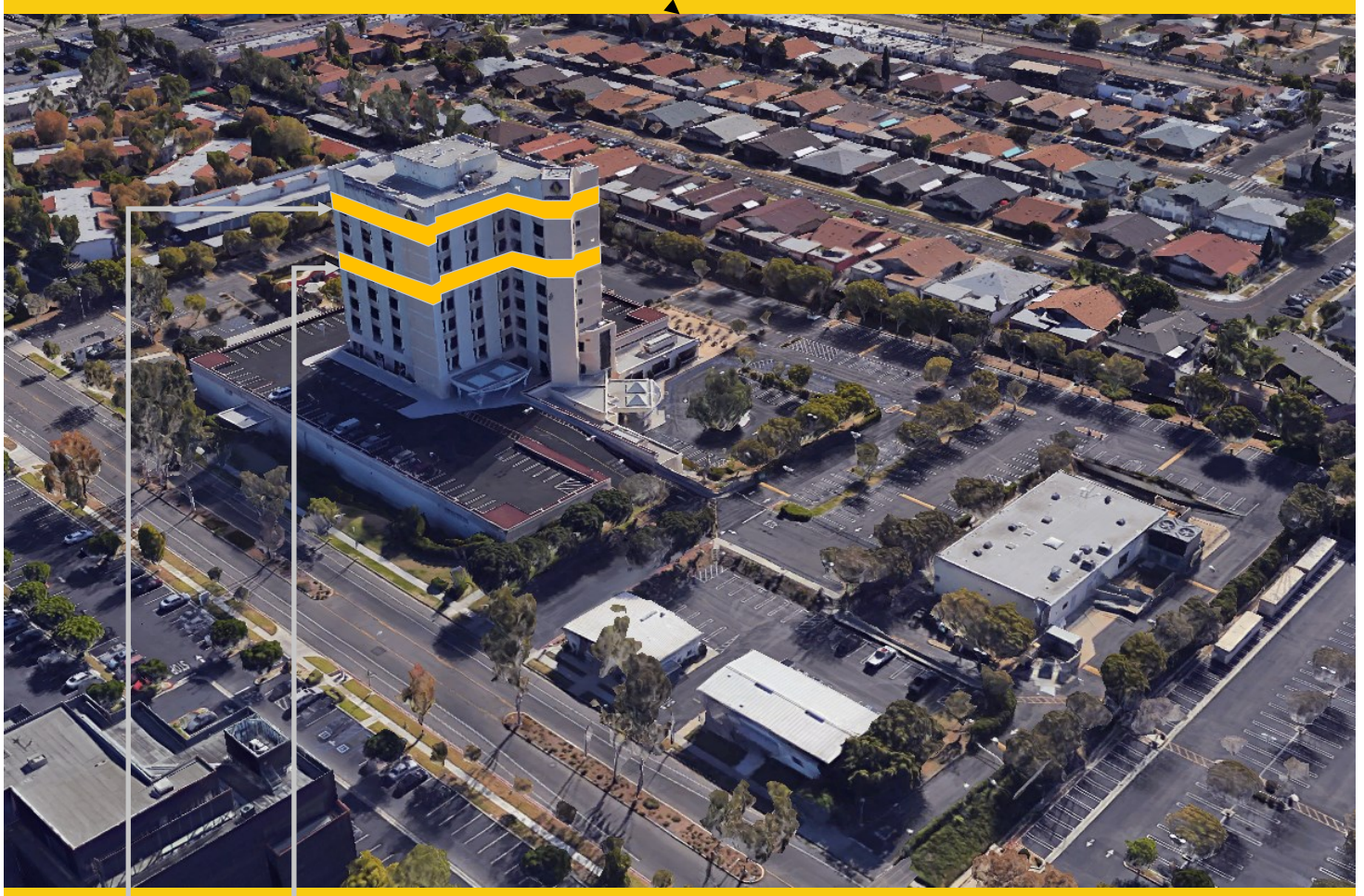

10th Floor Buildout  
[Close-Out]



7th Floor Buildout  
[Close-Out]

IT Network Refresh  
(Throughout Campus)  
[Implementation]







**North Orange County Community College District**  
**Measure J And Other Funding**  
**Finance Report**  
**March 31, 2020**



NORTH ORANGE COUNTY  
 COMMUNITY COLLEGE DISTRICT

**Anaheim**

Description	Revenue		Total Budget (all sources)	Budgeted Expenses			Expenses to Date 03/31/2020	Forecasted Total Cost	Variance Budget - Forecast	Start Date	End Date	Status
	Bond	State		Local	Hard Cost	Soft Cost						
Reactivate 1st Floor Warehouse Areas for Storage	202,000	-	1,252,000	713,640	388,120	150,240	788,583	-	-	6/1/16	4/11/17	N/A
7 <sup>th</sup> and 10 <sup>th</sup> Floors Buildout	2,151,359	-	6,038,776	3,442,102	1,872,021	724,653	5,172,345	-	-	3/1/16	12/31/19	N/A
5 <sup>th</sup> Floor CTE & 2 <sup>nd</sup> Floor Room 215 Repurpose Childcare	640,736	-	640,736	403,413	168,887	41,956	640,736	-	-	6/1/17	7/1/19	N/A
Second Floor Tenant Improvements	1,246,200	-	1,246,200	710,334	386,322	149,544	-	-	-	10/1/20	6/15/23	N/A
Outdoor Patio Remodel	813,000	-	813,000	463,410	252,030	97,560	-	-	-	3/28/22	2/24/23	N/A
Fourth Floor Improvements	1,382,500	-	1,382,500	788,025	428,575	165,900	-	-	-	5/26/21	2/23/22	N/A
Update/Improve Infrastructure	218,000	-	218,000	124,260	67,580	26,160	-	-	-	4/27/22	6/27/23	N/A
Update/Improve Infrastructure (IT)	766,540	-	766,540	436,928	237,627	91,985	-	-	-	5/15/18	12/31/25	N/A
Planning (Non Project Specific)	1,000,000	-	1,000,000	570,000	310,000	120,000	198,700	-	-	7/24/19	8/17/21	N/A
Student Lounge	440,000	-	440,000	-	440,000	-	9,475	-	-	6/1/16	12/29/23	N/A
Upper Deck Parking Lot Remodel	217,720	-	217,720	124,100	67,493	26,126	-	-	-	5/26/21	7/26/22	N/A
Develop Interior and Exterior Signage	1,104,500	-	5,000,000	2,850,000	1,550,000	600,000	-	-	-	12/11/18	10/12/22	N/A
Enliven Corridors/Develop Areas for Student Collaboration	313,800	-	313,800	178,866	97,278	37,656	-	-	-	6/16/22	3/16/23	N/A
Develop South Entry Plaza	888,800	-	888,800	506,616	275,528	106,656	-	-	-	10/1/20	3/2/22	N/A
Develop East Entry Plaza	816,800	-	816,800	465,576	253,208	98,016	-	-	-	8/2/28	8/30/30	N/A
Remove Planters/Create Japanese Rock Garden	413,200	-	413,200	235,524	128,092	49,584	-	-	-	8/2/28	11/30/29	N/A
Reconfigure Parking Lots	309,901	-	309,901	176,644	96,069	37,188	-	-	-	4/1/24	8/29/25	N/A
Develop Drop-Off Plaza at Romneya Drive	2,099,000	-	2,099,000	1,196,430	650,690	251,880	-	-	-	9/1/26	8/31/28	N/A
Develop Intersection at Romneya & Coronet	1,069,000	-	1,069,000	609,330	331,390	128,280	-	-	-	9/1/26	9/29/28	N/A
Holding Account	914,744	-	914,744	521,404	283,571	109,769	-	-	-	9/1/26	1/31/29	N/A
<b>Anaheim Campus Total:</b>	<b>20,607,800</b>	<b>-</b>	<b>29,440,717</b>	<b>14,516,602</b>	<b>8,284,481</b>	<b>6,613,154</b>	<b>6,809,839</b>	<b>-</b>	<b>-</b>	<b>8/1/19</b>	<b>12/31/30</b>	<b>N/A</b>

<b>PROJECTS</b>												
<b>District &amp; Other Expense</b>												
Program Management Cost	20,000,000	-	20,000,000	-	-	-	3,917,100	-	-	11/1/15	12/31/30	N/A
Bond Issuance Costs	3,544,600	-	3,544,600	-	-	-	1,301,760	-	-	6/1/16	12/31/27	N/A
Other Bond Expenses	800,000	-	800,000	-	-	-	260,852	-	-	11/1/15	12/31/30	N/A
<b>Total District</b>	<b>24,344,600</b>	<b>-</b>	<b>24,344,600</b>	<b>-</b>	<b>-</b>	<b>-</b>	<b>5,479,712</b>	<b>-</b>	<b>-</b>	<b>-</b>	<b>-</b>	<b>N/A</b>

**General Notes:**

# PROJECT STATUS REPORT — ANAHEIM CAMPUS

## 7th AND 10th FLOORS BUILDOUT CLOSE-OUT

<b>Address</b>	<b>1830 W. Romneya Dr. Anaheim, CA 92801</b>
<b>Project Manager</b>	<b>Rick Williams NOCCCD</b>
<b>Architect</b>	<b>R<sup>2</sup>A Architecture</b>
<b>General Contractor</b>	<b>Paul C. Miller Construction Co.</b>
<b>Project Gross Square Footage</b>	<b>19,630 GSF (7th &amp; 10th)</b>
<b>Project Delivery Method</b>	<b>Design - Bid - Build</b>
<b>DSA Application A#</b>	<b>04-115733</b>



### Project Overview

The 7th floor remodels will accommodate NOCE’s needs for assessment centers, while the 10th floor will accommodate the District’s Vice Chancellor, Educational Services & Technology Department.

### Budget & Construction Costs

- Funding Sources.....Measures X & J
- Total Project Budget (Est.) ..... \$6,038,776
  - Measure X (Est.) ..... \$3,887,417
  - Measure J (Est.) ..... \$2,151,359
- Construction Cost..... \$3,729,097
  - Contracted Amount..... \$3,574,000
  - Contracted Allowance..... \$200,000
    - Allowance Used..... \$167,902
    - Allowance Balance ..... \$32,098
  - Authorized Change Orders ..... \$155,097

### Schedule

- Design Start..... May 31, 2016
- Construction Start ..... Dec. 18, 2017
- Substantial Completion..... Apr. 2019
- Construction Completion..... May 2019
- Occupancy.....Jun. 2019



# PROJECT STATUS REPORT – ANAHEIM CAMPUS

## UPDATE/IMPROVE INFRASTRUCTURE

### IMPLEMENTATION

<b>Address</b>	<b>1830 W. Romneya Dr. Anaheim, CA 92801</b>	<b>Total Project Budget</b>	<b>\$1,766,540 (Measure J)</b>
		<b>Total Budget Allocated</b>	<b>\$1,000,000 (Measure J)</b>
<b>Number of Projects</b>	<b>1</b>	<b>Funding Source</b>	<b>Measure J &amp; Capital Outlay</b>

### General Overview

Projects to address infrastructure improvements or upgrades throughout the Campus. Funds are allocated to projects as needs are identified.

### IT Network Refresh Project Overview

#### BIDDING

Assessment of Campus data network infrastructure to identify necessary upgrades, and changes that will enable supporting future campus needs; specifically addressing wired, wireless, voice, and video networks. Design of a new network will account for the District’s needs specific to logical infrastructure for the next 10 years. Physical infrastructure will also account for the District’s needs for the next 20 years. The scope includes replacing network core switches, providing a more responsive support structure, preparing for cloud computing, and adaptation of voice over IP systems across the District.

- Project Budget ..... \$5,270,400
  - Current Implementation (Measure J) ..... \$760,825
  - Current Implementation (Capital Outlay) ..... \$4,270,400
  - Upcoming Phases (Measure J) ..... \$239,175
- Funding Source ..... Measure J & Capital Outlay Funds
- Project Delivery Method ..... California Multiple Award Schedule (CMAS)
- Design Implementation ..... VectorUSA
- Architect ..... Shandam Consulting
- Project Management ..... District IS / PlanNet Consulting
- Design Implementation Start ..... November 2019
- Targeted Completion ..... October 2020



# PROJECT STATUS REPORT – ANAHEIM CAMPUS

## UPDATES ON CAMPUS PROJECTS - ANAHEIM CAMPUS

### 7th and 10th Floors Buildout

- DSA issued a Certification of Compliance letter on November 15th, 2019 marking the fulfillments of all requirements by DSA and adherence to the project construction drawings and specifications.

### Update / Improve Infrastructure

#### IT Network Refresh Project

- A Change Order will be released for review and approval of the District in late April. It encompasses a new parts list that will be provided to the District with potential zero cost impacts but is inclusive of a schedule impact to the project completion date.
- Implementation work proceeds at the site during the current Stay At Home directive from the State's Governor. VectorUSA is following recommendations from the CDC on social distancing and hygiene practices for all its employees.



# CURRENT PROJECTS

- Key Milestones and Decisions to the Board of Trustees
- 30-Day Look Ahead
- 90-Day Look Ahead Schedule



# CURRENT PROJECTS

## Key Milestones and Decisions to the Board of Trustees

ITEM	ESTIMATED PRESENTATION TO THE BOARD
(None)	(None)



# CURRENT PROJECTS

## 30 - DAY LOOK AHEAD SCHEDULE

ACTIVITIES	RESPONSIBILITY	STATUS
<b>Cypress</b> - New Science, Engineering, & Mathematics Building - Placement of decking of columns and beams for South and North wings of building.	Cypress PM, Sundt, LPA	Complete
<b>Cypress</b> - New Science, Engineering, & Mathematics Building - Mechanical, electrical, and plumbing rough-in.	Cypress PM, Sundt, LPA	In Progress
<b>Cypress</b> - New Science, Engineering, & Mathematics Building - Fireproofing protection installation	Cypress PM, Sundt, LPA	In Progress
<b>Cypress</b> - New Science, Engineering, & Mathematics Building - Concrete pour for second and third floors.	Cypress PM, Sundt, LPA	In Progress
<b>Cypress</b> - New Science, Engineering, & Mathematics Building - IDC structural steel framing for roof and equipment support.	Cypress PM, Sundt, LPA	In Progress
<b>Cypress</b> - New Veterans' Resource Center & Student Activities Center - Scaffolding Erection and Installation of Exterior Framing and Glazing	Cypress PM, Sundt, LPA	In Progress
<b>Cypress</b> - New Veterans' Resource Center & Student Activities Center - VRC Installation of Curtain Wall	Cypress PM, Sundt, LPA	In Progress
<b>Cypress</b> - New Veterans' Resource Center & Student Activities Center - VRC Interior Framing. Installation of overhead plumbing, fire sprinklers, electrical and communication.	Cypress PM, Sundt, LPA	Complete
<b>Cypress</b> - New Veterans' Resource Center & Student Activities Center - VRC Installation of lathe and plaster.	Cypress PM, Sundt, LPA	Complete
<b>Cypress</b> - New Veterans' Resource Center & Student Activities Center - SAC Interior Framing and Installation of Drywall. Installation of overhead plumbing, fire sprinklers, electrical and communication. Installation of partitions.	Cypress PM, Sundt, LPA	In Progress
<b>Cypress</b> - New Veterans' Resource Center & Student Activities Center - VRC/SAC installation of acoustical ceiling grid and ceiling light fixtures.	Cypress PM, Sundt, LPA	In Progress
<b>Cypress</b> - New Veterans' Resource Center & Student Activities Center - VRC/SAC installation of finishes.	Cypress PM, Sundt, LPA	In Progress
<b>Cypress</b> - Veterans' Memorial Bridge and Tribute Garden - Concrete Sidewalks, Benches, and Curbs.	Cypress PM, Sundt, LPA	In Progress
<b>Cypress</b> - Pond Refurbishment - Retaining walls, pond shoreline, and irrigation installation.	Cypress PM, Sundt, LPA	Complete
<b>Cypress</b> - Pond Refurbishment - Installation pond basin waterproofing, testing, and installation of mushroom jets and lights.	Cypress PM, Sundt, LPA	Complete
<b>Fullerton</b> - New Instructional Building - Rerouting of 6" Gas Line and 6" Chilled Water Lines feeding Building 1400	Fullerton PM, BN Builders, RNT Arch.	In Progress
<b>Fullerton</b> - New Instructional Building - Demolition of Existing Parking Lot	Fullerton PM, BN Builders, RNT Arch.	In Progress



# CURRENT PROJECTS

## 30 - DAY LOOK AHEAD

ACTIVITIES	RESPONSIBILITY	STATUS
<b>Fullerton</b> - New Instructional Building - Cutting and capping all existing utilities and rerouting existing utilities.	Fullerton PM, District, BN Builders, RNT Arch.	In Progress
<b>Fullerton</b> - New Instructional Building - Structure Foundation Work	Fullerton PM, District, BN Builders, RNT Arch.	Upcoming
<b>Fullerton</b> - Central Plant Expansion - Site excavation and foundation work.	Fullerton PM, District, BN Builders, RNT Arch.	In Progress
<b>Fullerton</b> - 300-500 Sewer Line Replacement - Bidding for General Contractor . Request for Proposals due on April 15th, 2020	Fullerton PM, District, R2A Arch.	In Progress
<b>Fullerton</b> - 300-500 Sewer Line Replacement - Selection of General Contractor based on submitted RFPs	Fullerton PM, District, R2A Arch.	Upcoming
<b>Anaheim</b> - Planning for Upper Deck Parking Lot refurbishment project.	Anaheim-NOCE, District, MAAS, R2A	On Hold
<b>District</b> - IT Network Refresh - Installation of copper and fiber infrastructure at Cypress College. Cable testing.	District, VectorUSA,	In Progress
<b>District</b> - IT Network Refresh - Installation of copper and fiber infrastructure at Anaheim—NOCE Campus and District Offices. Cable testing.	District, VectorUSA,	In Progress
<b>District</b> - IT Network Refresh - Copper and fiber infrastructure discovery, planning, and design for Fullerton College	District, VectorUSA,	In Progress
<b>District</b> - Update Project Execution Plan and Project Estimating worksheets Target for Campus submissions within PROMPT.ed 05/08/20.	MAAS, District, Anaheim, Cypress &	Ongoing
<b>District</b> - Update of Allowance, Potential Change Order, and Change Order logs. Target for Campus submissions for active projects within PROMPT.ed—05/08/20.	MAAS, District, Anaheim, Cypress &	Ongoing





# CURRENT PROJECTS

## 90 - DAY LOOK AHEAD



NORTH ORANGE COMMUNITY COLLEGE DISTRICT  
**CYPRESS - FULLERTON - ANAHEIM (NOCE)**  
**90-DAY LOOK AHEAD SCHEDULE**



(04-01-20 TO 06-30-20)

	April			May				June					Comments	
	7	14	21	28	5	12	19	26	2	9	16	23		30
<b>GENERAL</b>														
NOCCCD Board Meetings														
COC Meetings														Jun. 3, Sep. 2, and Dec. 2, 2020
Bond Program Management Team Mtgs.														Apr. 21, forthcoming meetings for be scheduled
<b>PLANNING</b>														
<b>DESIGN PHASE</b>														
<b>CYPRESS</b>														
Mass Communications - Security Cameras														Development of Scope and Budget
Update Infrastructure - Central Plant Enhancements														Development of Scope and Budget
<b>DSA PHASE &amp; AGENCY REVIEW</b>														
<b>FULLERTON</b>														
Deferred Approvals for New Instructional Building														1 Deferred Approval under Review at DSA. 1 Pending Submittal
Deferred Approvals for Central Plant Expansion														No Deferred Approvals
<b>PRE-CONSTRUCTION PHASE</b>														
<b>CYPRESS</b>														
Mass Communications - Security Cameras														Anticipated Implementation of Scope of Work
Update Infrastructure - Central Plant Enhancements														Anticipated Implementation of Scope of Work
<b>FULLERTON</b>														
300-500 Sewer Line Replacement														Bidding in Progress - Selection of Contractor Based on Submitted Bids
<b>CONSTRUCTION PHASE</b>														
<b>CYPRESS</b>														
Network Refresh Physical Layer Infrastructure														Installation of Cabling and Hardware - Complete
Network Refresh Design Implementation														Testing of Cabling
New SEM & Assoc. Mass Comm and Infra. Construction														Steel Decking and Seismic Bracing Installation
New SEM & Assoc. Mass Comm and Infra. Construction														Erection of North Elevation Scaffolding - Complete
New SEM & Assoc. Mass Comm and Infra. Construction														Mechanical, Electrical, and Plumbing Rough-In
New SEM & Assoc. Mass Comm and Infra. Construction														Concrete pours for second and third floors
New SEM & Assoc. Mass Comm and Infra. Construction														Fireproofing protection installation
New SEM & Assoc. Mass Comm and Infra. Construction														IDC Structural Steel Framing for Equipment and Roof Support
New VRC/SAC & Assoc. Mass Comm and Infra. Construction														VRC Exterior Finishes
New VRC/SAC & Assoc. Mass Comm and Infra. Construction														VRC Interior Finishes
New VRC/SAC & Assoc. Mass Comm and Infra. Construction														VRC Curtain Wall and Curtain Wall Glass Installation
New VRC/SAC & Assoc. Mass Comm and Infra. Construction														VRC Lathe and Plaster Installation - Complete
New VRC/SAC & Assoc. Mass Comm and Infra. Construction														VRC Roof Installation - Complete
New VRC/SAC & Assoc. Mass Comm and Infra. Construction														SAC Interior Framing - Rough Install of HVAC & Plumb. - Complete
New VRC/SAC & Assoc. Mass Comm and Infra. Construction														SAC Interior Framing - Partitions, Soffits, Backing
New VRC/SAC & Assoc. Mass Comm and Infra. Construction														SAC Wall Framing and Drywall Installation
New VRC/SAC & Assoc. Mass Comm and Infra. Construction														VRC/SAC Acoustical Ceiling Grid and Ceiling Light Fixtures Installation
New VRC/SAC & Assoc. Mass Comm and Infra. Construction														VRC/SAC Sprinkler and Fire Alarm Components
Veterans' Memorial Bridge and Tribute Garden and Pond Refurb.														Concrete Sidewalks, Benches, Curbs
Veterans' Memorial Bridge and Tribute Garden and Pond Refurb.														Installation of Landscaping & Exterior Furniture
Pond Refurbishment														Installation of Mushroom Jets and Lights - Complete
<b>FULLERTON</b>														
New Instructional Building														Construction - Site Work and Foundations
New Instructional Building - Reroute Unforeseen Utilities														Potholing, Trenching, and Switch Over of Existing Utilities
Central Plant Expansion														Construction - Site Work and Foundations
Network Refresh Site Assesment & Design Implementation Review														Installation of Cabling and Hardware - Upcoming
<b>ANAHEIM (NOCE)</b>														
Network Refresh Procurement of Materials and Equipment														In Progress
Network Refresh Physical Layer Infrastructure														Installation of Cabling and Hardware
Network Refresh Physical Layer Infrastructure														Testing of Cabling
<b>CLOSE-OUT PHASE</b>														
<b>CYPRESS</b>														
Veterans' Memorial Bridge and Tribute Garden and Pond Refurb.														Upcoming
Pond Refurbishment														Upcoming

\* Non-Measure J expenditure activities



**Intentionally Left Blank**

# COMPLETED PROJECTS

– CYPRESS COLLEGE

– NOCE – ANAHEIM CAMPUS & DISTRICT OFFICES



# COMPLETED PROJECTS

## Cypress College

Project Name	Funding Sources	Final Project Cost	Completion Date
Swing Space Projects - Gym II Improvements	Measure J	\$153,402	July 2018
Swing Space Projects - Parking Lot 5 Realignment	Measure J	\$1,957,594	September 2018
Mass Communication & Security Systems Upgrade: Safety Film	Measure J	\$145,774	January 2019
Mass Communication & Security System Upgrade: Door Replacement	Measure J	\$50,898	January 2019



Completed Parking Lot 5 Realignment from the LLRC at Cypress College

# COMPLETED PROJECTS

## NOCE—Anaheim Campus & District Offices

Project Name	Funding Sources	Final Project Cost	Completion Date
5th Floor CTE Laboratory and 2nd Floor Room 215	Measure J	\$640,736	September 2018

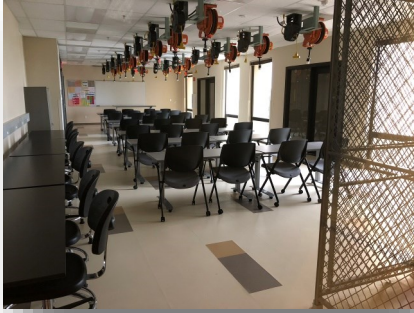

Views of the Completed 5th Floor CTE Lab for North Orange Continuing Education at Anaheim Campus

**April 2020**

# **Board of Trustees Report**

**BOT**

## **Measure J Bond Program**

